

PUMP-RITE

Est. 1978



Catalogue Index

Introduction		03
Parker Global Air Preparation System		05
Section 1	Pneumatic Grease Pumps	08
Section 2	Manual Grease Pumps	24
Section 3	Hose Reels	34
Section 4	Pneumatic Oil Pumps	45
Section 5	Manual Oil & Fuel Pumps	56
Section 6	Grout & Wash Pump Derivatives	65
Section 7	Chemical Pumps	71
Section 8	Electric Pumps	75
Section 9	Combination Trolleys	84

PUMPRITE RANGE OF TRANSFER PUMPS, LUBRICATION AND ALLIED EQUIPMENT

Product Transferred:

Grease, Oil, Chemicals, Grout/Cement, Air, Water, Petroleum, Antifreeze, Hydraulic Oils, Diesel Fuel, Detergents and Allied Products.

Applications:

Transfer Of Product, Lubrication Of Machinery, Greasing, Pack Setting, Rock Grouting, Washing, Fixed Systems, Mobile Systems, Drag lines etc.

Sectors Covered:

Mining Sector, Agriculture, Repair Garages, Service Stations, Municipality Maintenance, Road Maintenance, Military, Workshops, Mechanical Engineering, Chemical Industry, Building Sector, Manufacturing Industry in General.

About Pumprite:

- ✍ Established in 1978
- ✍ Nationally recognized
- ✍ Over 20 000 pumps sold
- ✍ Established as the quality product in the field of Lubrication Equipment
- ✍ Personalized attention to even the smallest requirements
- ✍ 100% Locally manufactured in South Africa
- ✍ **Same day service**
- ✍ **Spares are readily available**
- ✍ Direct from the factory to you
- ✍ BEE Compliant

TOP QUALITY, COST EFFECTIVE, AND AVAILABLE.

QUALITY ASSURANCE POLICY

We are committed to a policy of quality assurance and will endeavor to establish, document, communicate, understand, implement, maintain, review, and continually improve the quality policy and the quality management system throughout the organisation.

This means we will consistently supply products and services that meet their intended purpose, stated performance criteria and in conformance with the requirements of the customer.

Our quality policy is directed towards achieving the following objectives for customers measurable by exception:

- ✎ Ensure products comply with stated specifications and performance standards.
- ✎ Ensure products are manufactured & assembled within the agreed time or sooner.
- ✎ Ensure capability to customize products to customers requirements if necessary.





Parker Global Air Preparation System

Global.
Economical.
Modular.
Performance you need,
wherever you need it.



The comprehensive Global Air Preparation System is available in three body sizes with either BSPP or NPT to accommodate thread type requirements.

Full featured filters, regulators, filter/regulators, and lubricators are available with a wide range of standard options to meet air preparation needs.

Individual units can easily be assembled into various combinations, utilizing patented modular lightweight body connectors.

www.parker.com/globalfrl



Comprehensive Offering



P31 Mini Series
1/4" ports
40mm body width



P32 Compact Series
1/4", 3/8" and 1/2"
60mm body width



P33 Standard Series
1/2" and 3/4"
73mm body width



Filter

- 5µ particulate, 1.0µ and 0.01µ coalescing, and absorber available as standard
- Transparent or metal bowl with manual or auto float drains standard



Regulators

- Available as stand alone, common port and electronic proportional
- Both relieving and non relieving versions available



Filter/Regulators

- Compact design for space savings
- Available with all the same standard options as the filters and regulators



Lubricators

- Proportional oil delivery over a wide range of air flows
- Fill under pressure



Combinations

- Compact design for space savings
- Easily assembled
- Many configurations available



Accessories

- Solenoid operated soft start, quick dump, and soft start/quick dump valves
- Manifold blocks
- Shut-off slide valves
- Service kits, gauges, etc.

Pneumatic Division - Europe

Air Preparation

P31 Mini Series

40mm body width

1/4" Ported

Flows up to: dm³/s (SCFM)

Filter 12 (25)

Coalescer 2 (4.2)

Regulator 30 (64)

Filter/Regulator 14 (30)

Lubricator 13 (28)

Features:

- Space saving integral gauge
- Manifold style regulators available
- OSHA compliant shut-off valves
- Soft-Start & Quick Dump valves
- Electronic Proportional Regulator



P32 Compact Series

60mm body width

1/4", 3/8", & 1/2" Ported

Flows up to: dm³/s (SCFM)

Filter 38 (80)

Coalescer 11 (23)

Regulator 67 (142)

Filter/Regulator 64 (136)

Lubricator 47 (100)

Features:

- Manifold style regulators available
- OSHA Compliant shut-off valves
- Soft-Start & Quick Dump valves
- Electronic Proportional Regulator



P33 Standard Series

73mm body width

1/2" & 3/4" Ported

Flows up to: dm³/s (SCFM)

Filter 48 (102)

Coalescer 20 (42)

Regulator 100 (212)

Filter/Regulator 98 (208)

Lubricator 68 (144)

Features:

- OSHA Compliant shut-off valves
- Soft-Start & Quick Dump valves (Utilizes P32 size only)
- Electronic proportional regulator (Utilizes P32 size only)



SECTION 1

PUMPRITE PNEUMATIC GREASE PUMPS

MK-5 60:1 Grease Pump



85:1 MK-2 Grease Pump



Pneumatic 425



PUMPRITE Grease Master 75:1 Ratio

Latest Development...

EA Series 50:1 Slimline Grease Pump



Accessories

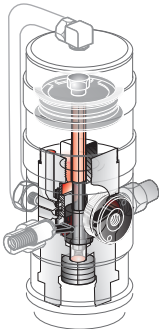

PUMPRITE
Est. 1978

SECTION 1: PUMPRITE PNEUMATIC GREASE PUMPS

There are 5 Pneumatic Grease Pumps manufactured in the PUMPRITE range within South Africa;

- ✎ MK5 60:1 Ratio Grease Pump,
- ✎ MK2 85:1 Ratio Grease Pump,
- ✎ MK1 75:1 Ratio Grease Master,
- ✎ Pneumatic 425 volume grease pump in 50:1 and 75:1 ratios, and the
- ✎ EA 50:1 Slimline Grease Pump.

LATEST DEVELOPMENTS AND NEW TOP SELLER...

The very exciting Pumprite Grease Master. A High Pressure 75:1 Ratio Grease Transfer Pump with a delivery exceeding 3kg of No. 2 Consistency Grease per minute.

PUMPRITE PNEUMATIC GREASE PUMPS:

- ✎ Are robust and can be stalled without damage. Their design has been refined to ensure failsafe operation & durability in service.
- ✎ All Pumprite Pneumatic Grease Pumps come with an airline lubricator for continuous lubrication & protection of the unit. This airline lubricator is fitted to the air inlet of the pump.
- ✎ **To Ensure Longevity of your Pump, Please Lubricate the Air Motor using CL1032 Lubricator Oil.**
- ✎ **Maximum air input 10 Bar, Minimum air input 4 Bar.**
- ✎ Delivery volume was derived using a **Lithium EP 2 Grease.**

PNEUMATIC GREASE PUMPS: CODE INFORMATION

The pneumatic grease pumps are coded according to additional accessories that can be included with the pump - e.g. if you are interested in a MK5 60:1 Grease Pump Complete with a LLDPE drum cover and metal follower plate for a 15kg grease drum, 2m Hydraulic Hose and Grease Control Handle, the code for this is **PRG-MK5-15-CDPF** where,

- ✎ **PRG** - Pumprite Grease
- ✎ **MK5** - Model of Pump.
- ✎ **15, 18, 25, 50, 180** - Container Sizes i.e. 15kg, 18kg, 25kg, 50kg, 180kg
- ✎ **B** - Bare Pump i.e. Air motor, Pump tube and airline lubricator.
The Pump tube length varies depending on the size of the grease container. This can be **custom made to any length** to suit special requirements.
- ✎ **BDPF** - Bare Pump with Robust LLDPE Drum Cover and Metal Follower Plate.
- ✎ **CDPF** - Bare Pump Complete with 2m 2 Wire 1/4" Hydraulic Hose, Z-Swivel and Rigid Grease Control Handle; Robust LLDPE Drum Cover and Metal Follower Plate.
- ✎ **RCPF** - Complete pump on Roller Cart Including an LLDPE shroud that accommodates the grease drum and a trolley for mobility. The pump is connected to the shroud. The shroud is un-clipped from the trolley via the 3 equidistant toggles. The container is placed on the trolley and the shroud is replaced over the container and is then re-clipped before use.

SPARES ARE ALWAYS READILY AVAILABLE FOR THESE PUMPS.

REPAIRS DONE TO ALL MAKES OF PNEUMATIC GREASE PUMPS.

PUMPRITE MK-5 60:1 GREASE PUMP

Ensure Air Motor Longevity with
CL1032 Lubricator Oil

The MK-5 is a newly improved Greasing unit based primarily on the tried and tested MK-3 PUMPRITE range of pneumatic grease pumps. The pump has a **double action** thus dispenses product on both the up and the down strokes. This provides a steady delivery. The pump is designed for all normal greasing applications. Tube lengths are made to suit 15kg, 18kg, 25kg, 50kg & 180kg grease drums.

TECHNICAL DATA

Fluid Pressure Ratio: 60:1

Size of Outlet: ¼"NPS

Delivery Volume: 1.95kg/min based on 8 Bar Regulated input pressure using Lithium EP 2.

Pressure Output: 430 Bar based on 8 Bar Regulated input pressure using Lithium EP 2.

Air Operating Range: 4 to 10 Bar air input.

The Technical Data was derived by pumping Lithium EP 2 Grease through a 50kg Pump Tube, 2m 1/4" Hydraulic Hose and Rigid Grease Control Handle with a **German Precision 4-Jaw Coupler**.

The Air Input was regulated at 8 Bar using the **Parker Global Air Preparation System** Filter/Regulator combination.

The 8 Bar input pressure ran the pump at 109 cycles per minute whilst pumping product.

Wetted parts: Steel; brass; aluminum; Nitrile; Teflon



PRG-MK5-25-B

- Air Motor
- Pump Tube

PRG-MK5-15-BDPF

- PRG-MK5-xx-B
- Metal Follower Plate
- Robust LLDPE Drum Cover

PRG-MK5-15-CDPF

- PRG-MK5-xx-BDPF
- 2m Hydraulic Hose
- Z-Swivel
- Rigid Control Handle

PRG-MK5-50-RCPF

- PRG-MK5-xx-B
- Shroud
- Roller Cart
- 2m Hose & C/Handle Assembly

PUMPRITE MK-5 50:1 GREASE PUMP SCHEMATIC

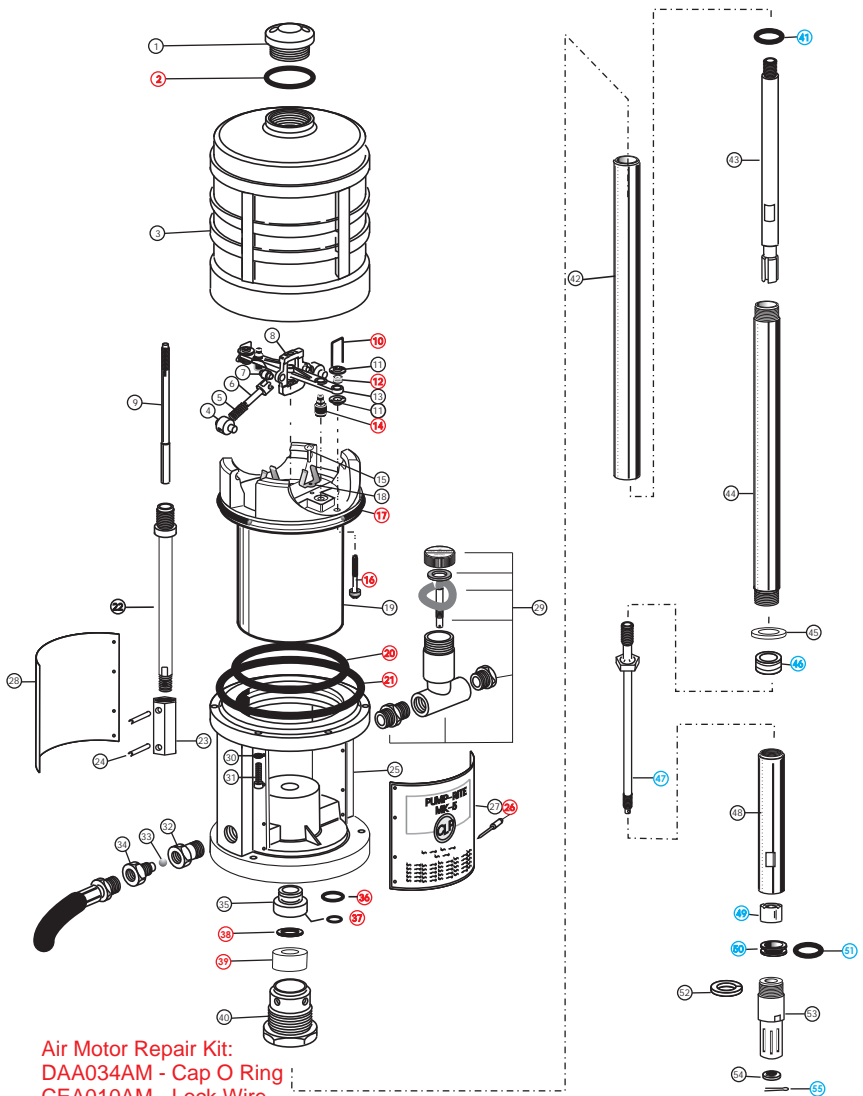

Air Motor Repair Kit:

- 02 DAA034AM - Cap O Ring
- 10 CEA010AM - Lock Wire
- 12 DCA003AM - Grommet
- 14 DCA001AM - Exhaust Valve
- 17 DAA097AM - Piston O Ring
- 16 DCA002AM - Inlet Valve Moulded onto Air Motor Stem
- 20 DAA075AM - Body O Ring
- 21 DAA107AM - Body to Cylinder O Ring
- 26 AEA002AM - Blind Rivet
- 36 DAA015AM - Outer O Ring
- 37 DAA012AM - Inner O Ring
- 38 DBA012AM - U Seal
- 39 DDA012AM - Rubber Body Seal

AIR MOTOR REPAIR KIT

TUBE REPAIR KIT

Tube Section Repair Kit:

- 41 DAA023AM - O Ring
- 46 JBA016AD - Piston
- 47 JCB014AM - Piston Shaft
- 49 JDA025AD - Shut Off Valve
- 50 JCA025AD - Valve Plate
- 51 DAA018AG - O Ring
- 55 AFB002AR - Split Pin

PUMPRITE MK-2 85:1 GREASE PUMP

Ensure Air Motor Longevity with
CL1032 Lubricator Oil

The Mk2 85:1 grease pump has been specifically developed for greasing applications where a very high pressure is needed or where long piping lines with various take off points are required. **The cylinder, body and Piston of the pump are Anodized for Longevity.** This pump is manufactured for a 50kg & 180kg drum. The follower plate can be fitted with a spring for stiff greases.

This Pump can be fitted with Teflon and Viton Seals where the pump is needed for continuous use at high temperatures.

TECHNICAL DATA

Fluid Pressure Ratio: 85:1

Size of Outlet: ¼"NPS

Delivery Volume: 1.9kg/min based on 8 Bar Regulated input pressure using Lithium EP 2.

Pressure Output: 700 Bar based on 8 Bar Regulated input pressure using Lithium EP 2.

The Technical Data was derived by pumping Lithium EP 2 Grease through a 50kg Pump Tube, 2m 1/4" Hydraulic Hose and Rigid Grease Control Handle with a **German Precision 4-Jaw Coupler.**

The Air Input was regulated at 8 Bar using the **Parker Global Air Preparation System** Filter/Regulator combination. The 8 Bar input pressure ran the pump at 150 cycles per minute.

Wetted parts: Steel; brass; aluminum, Nitrile, Teflon, Polyurethane.



PRG-85-50-B

- Air Motor
- Pump Tube (50kg or 180kg)

PRG-85-180-BDPF

- PRG-85-xx-B
- Metal Follower Plate
- LLDPE Drum Cover

PRG-85-180-CDPF

- PRG-85-xx-BDPF
- 2m Hydraulic Hose
- Z-Swivel
- Rigid Control Handle

PRG-85-50-RCPF

- PRG-85-50-CDPF
- Shroud
- Roller Cart 50kg Only

PUMPRITE Mk2 85:1 GREASE PUMP - REPAIR KIT

PRG-85-50-B
PRG-85-180-B

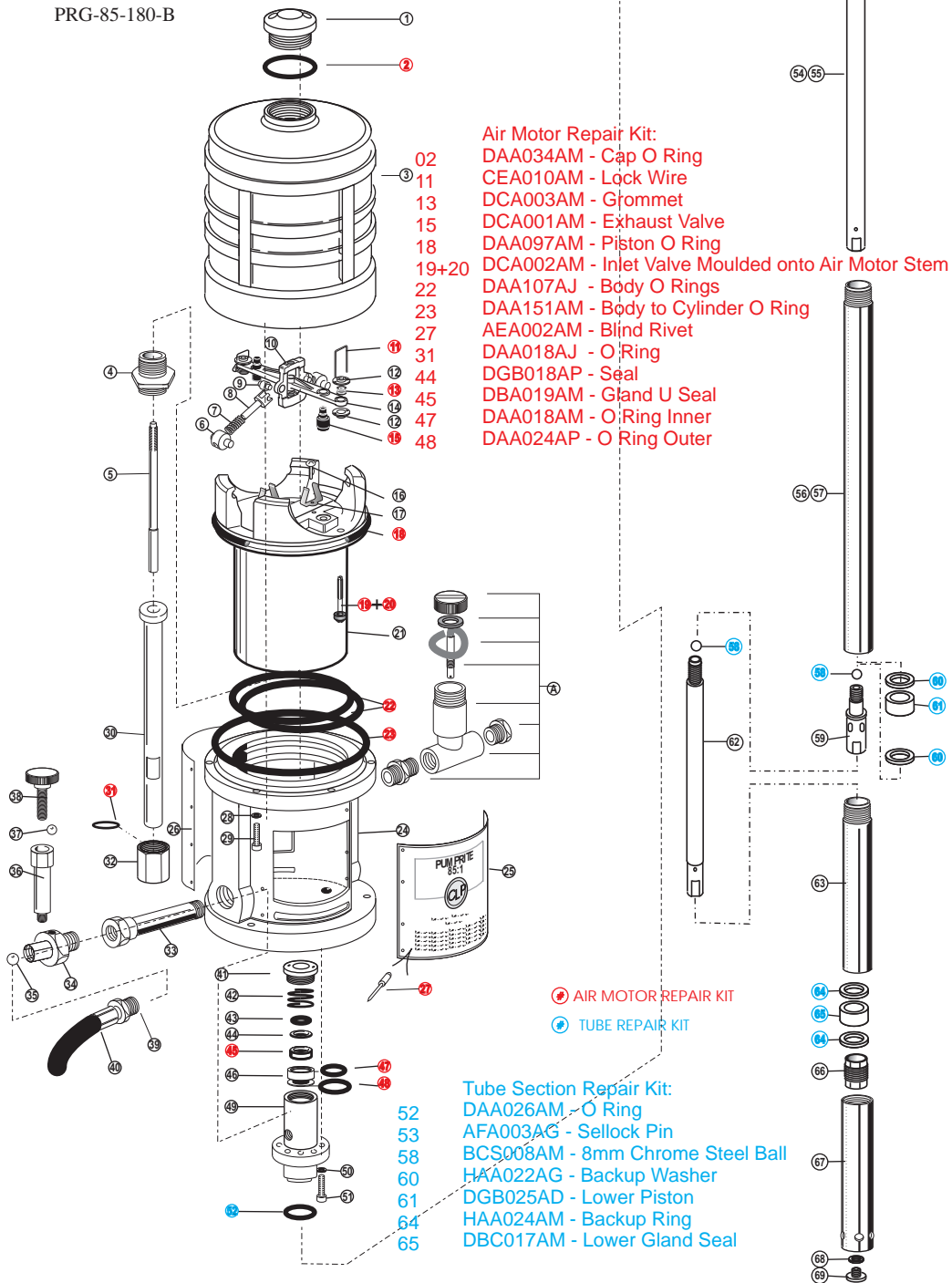

- Air Motor Repair Kit:**
- 02 DAA034AM - Cap O Ring
 - 11 CEAO10AM - Lock Wire
 - 13 DCA003AM - Grommet
 - 15 DCA001AM - Exhaust Valve
 - 18 DAA097AM - Piston O Ring
 - 19+20 DCA002AM - Inlet Valve Moulded onto Air Motor Stem
 - 22 DAA107AJ - Body O Rings
 - 23 DAA151AM - Body to Cylinder O Ring
 - 27 AEA002AM - Blind Rivet
 - 31 DAA018AJ - O'Ring
 - 44 DGB018AP - Seal
 - 45 DBA019AM - Gland U Seal
 - 47 DAA018AM - O'Ring Inner
 - 48 DAA024AP - O Ring Outer

- ✶ AIR MOTOR REPAIR KIT
- ✶ TUBE REPAIR KIT

- Tube Section Repair Kit:**
- 52 DAA026AM - O Ring
 - 53 AFA003AG - Sellock Pin
 - 58 BCS008AM - 8mm Chrome Steel Ball
 - 60 HAA022AG - Backup Washer
 - 61 DGB025AD - Lower Piston
 - 64 HAA024AM - Backup Ring
 - 65 DBC017AM - Lower Gland Seal

PUMPRITE PNEUMATIC 425

Ensure Air Motor Longevity with
CL1032 Lubricator Oil

The Pumprite Pneumatic 425 is mainly used for grease but can also be used to pump a variety of other products. The pump is used to convey product over long distances because of the pressure and volume capabilities. It is ideally suited for lubricating drag lines and is also used in the printing industry and for general greasing applications.

It is manufactured in a 50:1 ratio and a 75:1 ratio and is supplied with a durable one piece cover for protection and dust elimination. The Pneumatic 425 can also be 24:1 ratio as required.

TECHNICAL DATA 50:1

Fluid Pressure Ratio: 50:1
Delivery Output: 3kg/min
Pressure Output: 350 Bar
Size of outlet: ½" NPT
Stroke: 95mm
Weight of Pump: 32kg

TECHNICAL DATA 75:1

Fluid Pressure Ratio: 75:1
Delivery Output: 2.5kg/min
Pressure Output: 525 Bar
Size of Outlet: ½"NPT
Stroke: 95mm
Weight of Pump: 32kg

Durable LLDPE
one piece cover →



Pump Tube →



PRG-425-75-B

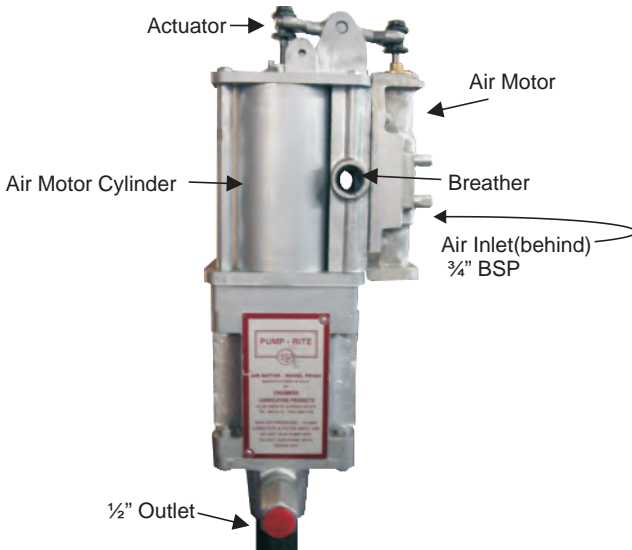

PUMPRITE 75:1 RATIO GREASE MASTER

Ensure Air Motor Longevity with
CL1032 Lubricator Oil

The Pumprite Grease Master is a combination between the superior quality Tube Section of the Pumprite Pneumatic 425 and the extremely reliable, long standing 6" G200 Air Motor. The result is an extremely robust, inexpensive High Pressure Application Pump.

The Pumprite Grease Master can be stalled without damaging the pump. The design has been refined to ensure fail-safe operation and durability in service. Due to the **Double Action Design**, delivery of the lubricant is even and non-pulsating.

The Pumprite Grease Master has a maximum air input of 10 Bar, the minimum air input is 4 Bar. The **Parker Global Air Preparation System Filter/Regulator combination** should always be fitted to the Airline to ensure that the Air input is regulated at a safe pressure somewhere between the minimum 4 Bar / maximum 10 bar input, and that all dirt and excess moisture is removed from the air before entering the air motor of the pump.

This high-pressure non-divorced grease pump (75:1 ratio) is designed to deliver a range of greases (up to NLGI # 3) and operate directly from either a 50kg or 180kg Standard Grease Drum. The tube section can be customized to suit your specific needs.

The Air Motor Piston, Body and Cylinder are all manufactured from **LM 25 Grade Aluminium and are Anodized** for extended wear life.

The Air Inlet is a 1/2" NPS. There is a Sintered Bronze Filter as well as an improved Lubricator at the inlet that will aid in the longevity of the air motor.

The Outlet of the Pump is a 1/2" NPS.

TECHNICAL DATA

The specifications for the Pumprite Grease Master have been derived by using a 1/2" Open ended hose 1m in length at around room temperature of 22°C using HIGH-LUB LT 2 EP, a multipurpose EP Grease.

Delivery per minute at 8 Bar input: 4kg
Pressure output at 8 Bar input: 600 Bar.
Max Working Pressure: 10 Bar
Min Working Pressure: 4 Bar



PUMPRITE GREASE MASTER SCHEMATIC

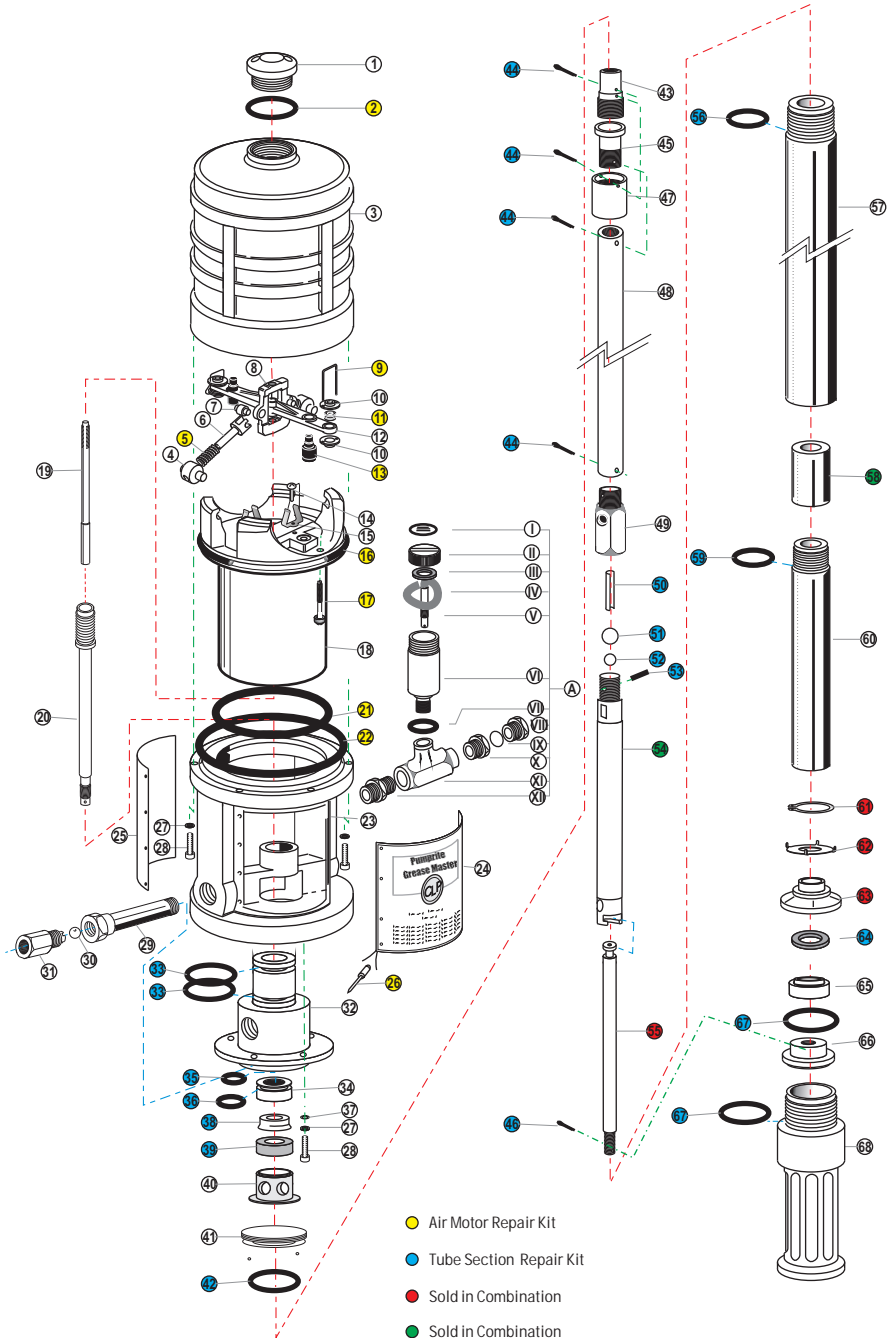

PUMPRITE GREASE MASTER SCHEMATIC PARTS LIST

8	IAA002AM	Shuttle	1	39	DDA017AM	Seal for Body Housing	1
9	CEA010AM	Lockwire	2	40	JAA050AJ	Spacer Bush GM	1
10	JBA020AD	Adjusting Nut	4	41	JFA060AD	Stop Nut For Spacer GM	1
11	DCA003AM	Grommet	2	42	DAA050AM	O Ring	1
12	IAA003AM	Air Motor Bar	1	43	JCA030AG	Piston Shaft Male Adaptor GM	1
13	DCA001AM	Exhaust Valve	2	44	AFB003AM	Split Pin	4
14	ABA003AM	BSW Cap Screw	2	45	JCA024AJ	Connection Tube Bolt	1
15	CGA040AM	Spring Clip	2	46	AFB002AR	Split Pin	1
16	DAA139AM	O Ring	1	47	JCA035AD	Connection Tube Spacer	1
17	DCA002AM	Inlet Valve	2	48	KAA025AM	Connection Tube	1
18	ICA110AM	Air Motor Piston	1	49	JCB030AJ	Adaptor GM	1
19	JCA012AJ	Trip Rod	1	50	AFA006AH	Sellock Pin	1
20	JCA022AM	Piston Shaft GM	1	51	BCS014AR	Upper Check Chrome Steel Ball	1
21	DAA107AJ	O Ring	1	52	BCS009AR	Chrome Steel Ball	1
22	DAA151AM	O Ring	1	53	HHA003AM	Pin	1
23	ICA120AM	Air Motor Body 75:1 GM	1	54	JCA024AG	Plunger GM	1
24	EAA001AA	Grease Master Name Plate	1	55	JDA016AM	Priming Plunger	1
25	EAA001AB	Grease Master Instruction Plate	1	56	DAA054AM	O Ring	1
26	AEA003AM	Blind Rivet	16	57	KBA060AM	Riser Tube GM	1
27	ACC008AM	Spring Washer	14	58	JCA045AJ	Bushing GM	1
28	ABA007AM	BSW Cap Screw	14	59	DAA040AM	O Ring	1
29	JBB030AP	Valve Adaptor GM	1	60	JFA060AG	Tube Adaptor GM	1
30	BCS009AR	Chrome Steel Ball	1	61	ADA015AM	Ext. Circlip	1
31	JBB030AD	Valve Body GM	1	62	CFA017AM	Guide	1
A	SAL012AM	Airline 1/2" Lubricator	1	63	JIA032AM	Priming Bush	1
				64	DBF041AM	Gasket - Powerflex	1
				65	JDA050AD	Valve Seat	1
				66	JCA040AD	Priming Nut	1
				67	DAA045AM	O Ring	2
				68	JBA055AJ	Primer Body GM	1

- Air Motor Repair Kit
- Tube Section Repair Kit
- Sold in Combination
- Sold in Combination

PUMPRITE EA SERIES 50:1 GREASE PUMP

Ensure Air Motor Longevity with
CL1032 Lubricator Oil

The Pumprite EA 50:1 Ratio grease pump complies with the industry standard for normal greasing applications. This pump fits onto the standard 15kg, 18kg, 25kg, 50kg & 180kg grease container sizes. The cylinder is manufactured from honed tubing and is coated by using the “chemically blackened process”. The body is anodized for strength and appearance.

This pump works very well with the Light Duty Reel and 180kg Drum Trolley Combination.

TECHNICAL DATA

Fluid Pressure Ratio: 50:1

Size of Outlet: 1/2” NPT

Delivery Volume: 550g/min based on 8 Bar Regulated input pressure using Lithium EP 2.

Pressure Output: 360 Bar based on 8 Bar Regulated input pressure using Lithium EP 2.

Product Code(s):

(xx is dependent on the drum size i.e. 15kg, 18kg, 25kg, 50kg or 180kg)

PRG-EA50-xx-B

PRG-EA50-xx-BDPF

PRG-EA50-xx-CDPF

PRG-EA50-xx-RCPF

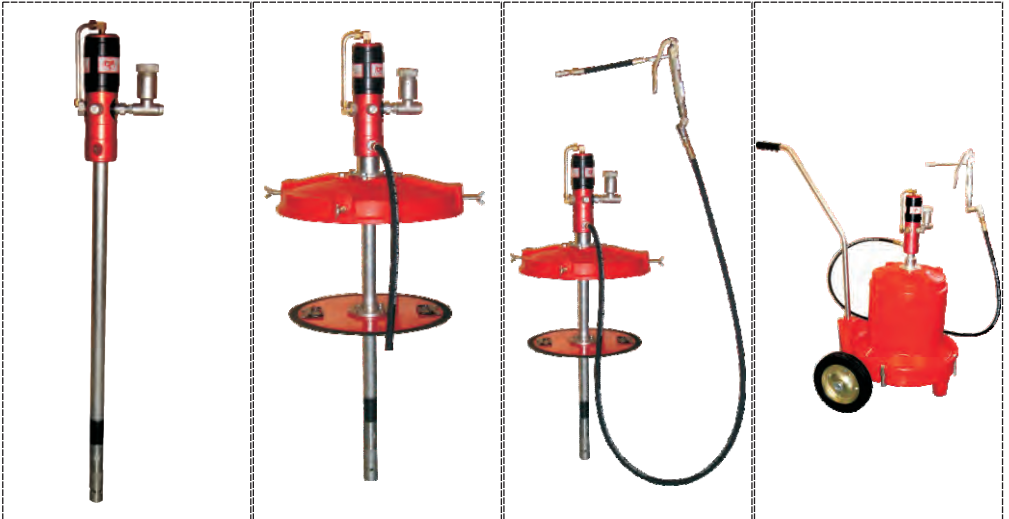

PRG-EA50-xx-B

- Air Motor
- Pump Tube

PRG-EA50-xx-BDPF

- PRG-EA50-xx-B
- Metal Follower Plate
- LLDPE Drum Cover

PRG-EA50-xx-CDPF

- PRG-EA50-xx-BDPF
- 2m Hydraulic Hose
- Z-Swivel
- Rigid Control Handle

PRG-EA50-xx-RCPF

- PRG-EA50-xx-CDPF
- Shroud
- Roller Cart

EA 50:1 GREASE PUMP EXPLODED REPAIR KIT DESCRIPTION

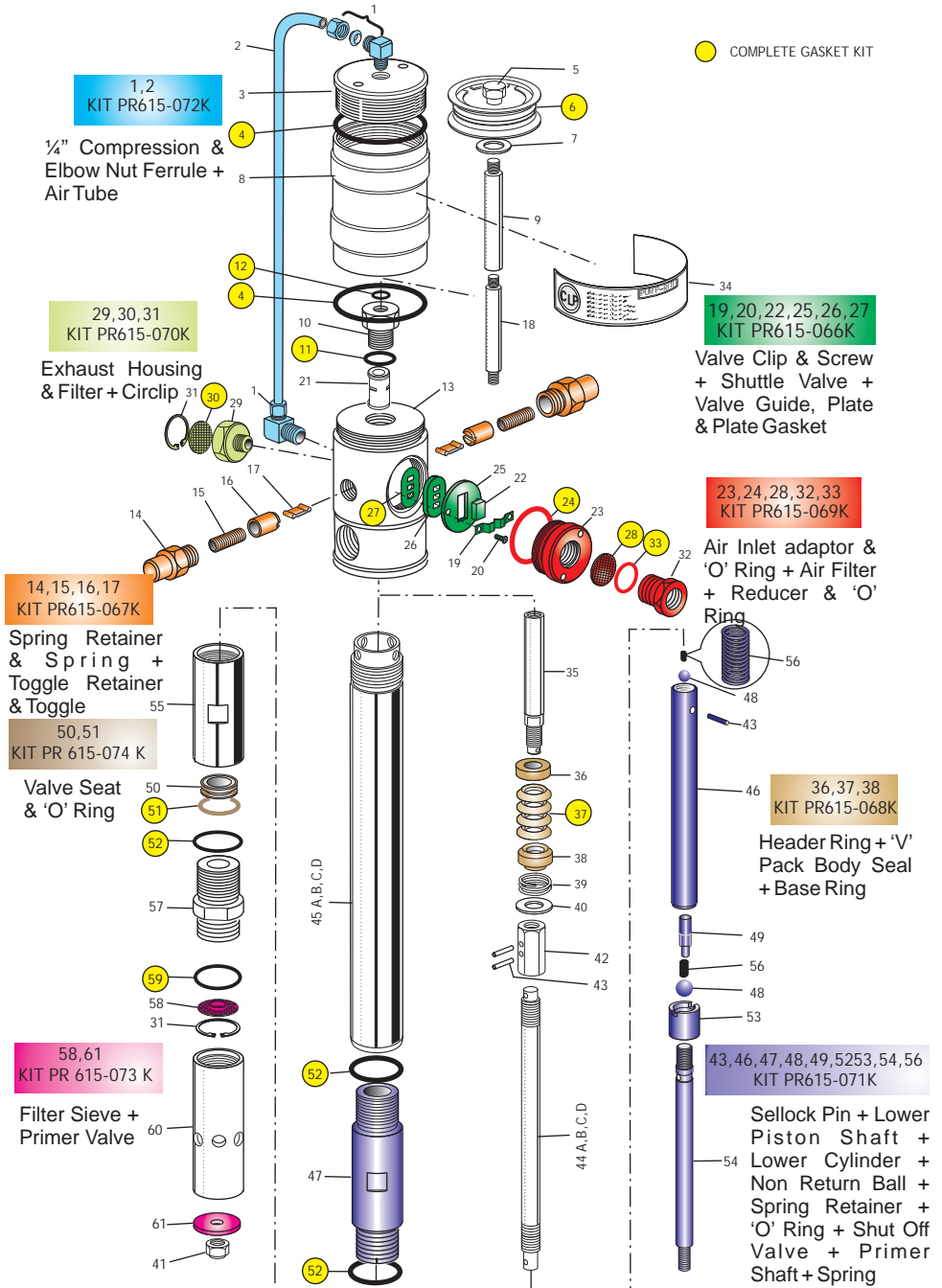

SPRING FEED LUBRICATOR

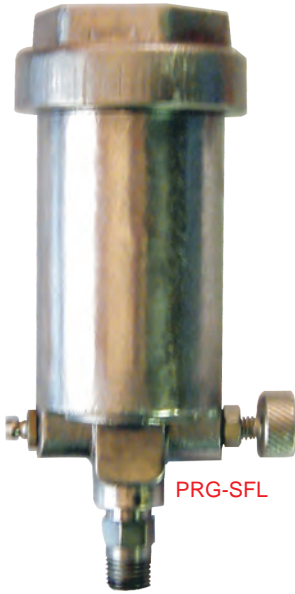

PRG-SFL

The Spring Feed Lubricator is used for automating the Greasing Process. It is used for machinery, bearing housings for conveyor systems and earth working vehicles. It has a visible indicator showing the grease level, a volume output adjustable screw mechanism and a ¼" NPT screw fitting to locate on the bearing. Various types of nipples are available for filling the Spring Feed Lubricator using either air operated or manual grease pumps.

TECHNICAL DATA

Capacity: 84cc

Size of Outlet: ¼" NPT

Weight of Lubricator: 600g

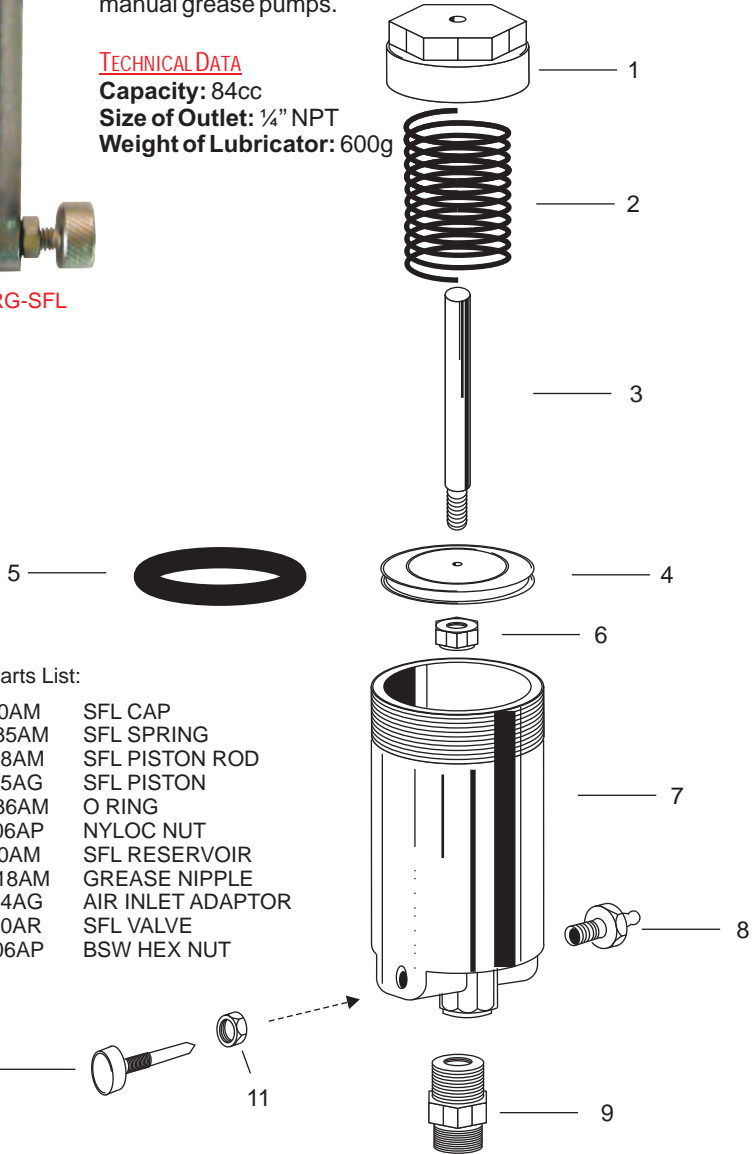

Schematic Parts List:

01	ICA280AM	SFL CAP
02	CAA035AM	SFL SPRING
03	JBA008AM	SFL PISTON ROD
04	JBA045AG	SFL PISTON
05	DAA036AM	O RING
06	AAA006AP	NYLOC NUT
07	ICA270AM	SFL RESERVOIR
08	GBA018AM	GREASE NIPPLE
09	JBB014AG	AIR INLET ADAPTOR
10	JBA020AR	SFL VALVE
11	AAB006AP	BSW HEX NUT

ACCESSORIES

GREASE CONTROL HANDLES

The Grease Control Handles are used with Pneumatically operated grease pumps. Both the flexible and the rigid grease control handles come with a **German Precision 4-Jaw Coupler**.

A **button head type coupler** is available on request.

THE FLEXIBLE GREASE CONTROL HANDLE

It enables access to hard to reach points by means of the flexible outlet. A hose of any length can be supplied as required. Please request the flexible grease control handle if required.

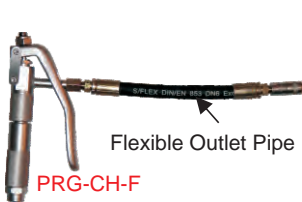

Flexible Outlet Pipe

PRG-CH-F

Pressure Rating: 500 Bar

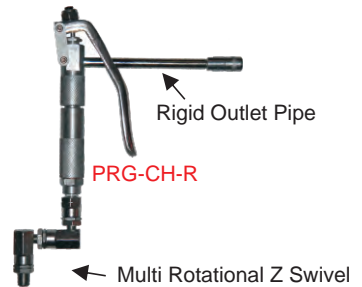

Rigid Outlet Pipe

PRG-CH-R

Multi Rotational Z Swivel

THE RIGID GREASE CONTROL HANDLE

The rigid outlet pipe is normally supplied straight, but can be bent to your requirements. A complete pump comes standard with a rigid grease control handle.

Pressure Rating: 500 Bar

1/4" Z SWIVEL

The Z Swivel is multi rotational. It is mainly used with the Grease Control Handle as an attachment to a Pneumatic Grease Pump.

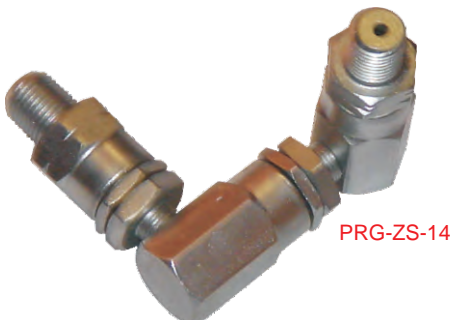

PRG-ZS-14

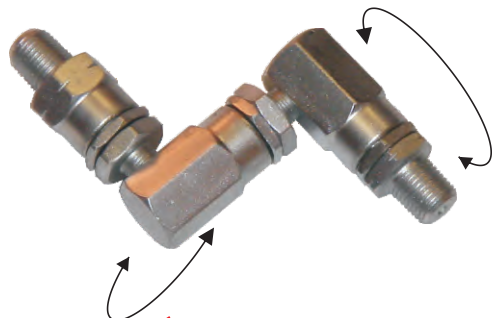

GREASING ACCESSORIES

SPRING LOADED GREASE COUPLER:



The Spring Loaded Grease Coupler was developed to address the shortfalls of a standard clip on type coupler.

- ✂ The +- 30% of grease that normally goes to **waste is minimised** by fitting a standard O Ring seal - easily replaceable in the field.
- ✂ Manually operated trigger reacts on a set of spring steel jaws to ensure correct alignment and easy connection and disconnection. Thus ensuring **Single man operation**.
- ✂ The easily interchangeable O-ring will need to be changed from time to time to get many **years of use** out of your Spring Loaded Grease Coupler.

German Precision Button Head Coupler

The UMETA slide coupler is equipped with the hose connection either at the top, or at the side - and it is made of aluminium or steel for optimal handling - according to each application. You achieve additional flexibility by using a swivel joint.



German Precision 4-Jaw Coupler

Hydraulic coupler

- ✂ Standard with punched jaws
- ✂ Suitable for hydraulic-type nipples



Assortment of Grease Nipples are Available upon Request



SECTION 2.

PUMPRITE MANUAL GREASE PUMPS

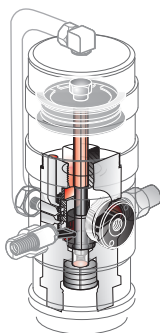
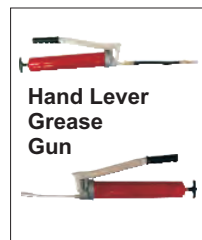

PUMPRITE
Est. 1978

SECTION 2: MANUAL GREASE PUMPS & ACCESSORIES

The Patented Spring Loaded 4-Jaw coupler has revolutionised the Pumprite Range of Manual Grease Pumps. It is a high pressure leak free coupler that ensures Single Person operation of our manual Grease pumps.

MANUAL GREASE PUMPS SUPPLIED IN THE PUMPRITE RANGE WITHIN SOUTH AFRICA:

The *Field Greaser*,





The *Bucket Grease Pump* in both a 5kg and a 15kg version,

The *Knapsack Grease Pump*, and





The *MK-2 Oval Bucket Grease Pump*.



Manual Grease Pumps in the PUMPRITE Range:

-  Wear and tear parts treated to improve longevity in operation.
-  Exposed Components treated to prevent corrosion.
-  Provided with a follower plate to wipe down the Pump tube and sides of the drum, preventing grease contamination and cavitation.
-  Developed and manufactured under the PUMPRITE name within South Africa.
-  Unique to the Pumprite Range of Manual Grease Pumps is the availability of **robust, durable, Lightweight LLDPE Polyethylene** Drum Covers and / or Buckets.

Also Supplied:

-  German Precision Hand Lever Grease Gun, both rigid & flexible.
-  German Precision One Hand Grease Gun, Both rigid and flexible.
-  German Precision 4 Jaw Grease Couplers
-  German Precision Button Head Grease Couplers

German Precision Button Head Coupler

Button-head coupler

The UMETA slide coupler is equipped with the hose connection either at the top, or at the side - and it is made of aluminium or steel for optimal handling - according to each application. You achieve additional flexibility by using a swivel joint.

German Precision 4-Jaw Coupler

Hydraulic coupler

- standard with punched jaws
- suitable for hydraulic-type nipples



SPARES ALWAYS READILY AVAILABLE FOR THESE PUMPS.
REPAIRS DONE TO ALL MAKES OF PNEUMATIC GREASE PUMPS.



PUMPRITE FIELD GREASER



SINGLE PERSON OPERATION WITH THE SPRING LOADED GREASE COUPLER

The Pumprite Field Greaser is used to pump grease or heavy oils from standard 15kg, 18kg, 25kg, or 50kg Grease Drums. Either high pressure or high volume delivery can be inexpensively achieved with this rugged, portable, manually operated, lightweight unit.

The Field Greaser is available in high pressure or high volume variations. The high volume variation can be used as a filler pump for centralized lubrication pots. All styles of the field greaser are placed directly onto the standard sized grease container and locked in position by tightening 3 thumb screws. **The grease is not touched by hand.**

The complete pump comes standard with 1.5m of 1/4" 1 wire hydraulic hose. The hose length can be varied as required. The **Spring Loaded 4-Jaw Grease Coupler** is now supplied as standard on the Pumprite Field Greaser Range which allows for 1 man operation. A roller cart can be supplied for the 15kg, 18kg, 25kg and 50kg field greaser variations. All sizes, but for the 18kg, come with variations of both the metal and the **robust, durable, lightweight LLDPE Polyethylene** drum cover. The 18kg is only available with a metal drum cover.

TECHNICAL DATA - HIGH PRESSURE VARIATION

Hose Length: 1.5m

Delivery Volume: 3.5g/stroke

Pressure Output: 42Mpa

15kg, 18kg, 25kg And 50kg Field Greaser Variations

<p>18kg Metal Field Greaser PRM-FG-18-M</p>	<p>15kg LLDPE Field Greaser PRM-FG-15-P</p>	<p>15kg Field Grease on Roller Cart PRM-FG-15-PRC</p>

PUMPRITE BUCKET GREASE PUMP



The Pumprite Bucket Grease Pump is a portable manually operated greasing unit with its own 5kg or 15kg container. The **15kg unit is available in a high pressure and a high volume variation**. The high volume variation can be used as a filler pump for centralized lubrication pots.

The 5kg unit is only available in metal whereas the 15kg unit is available in both metal and a **robust, durable, lightweight LLDPE Polyethylene**.

The complete pump comes with the New Patented **Spring Loaded 4-Jaw Grease Coupler**.

A button head coupler is available on request. The standard length hydraulic hose is 1.5m but this length can be varied according to requirements.

TECHNICAL DATA 15KG: HIGH PRESSURE VARIATION:

Hose Length: 1.5m
Delivery Volume: 285g/20 strokes
Pressure Output: 54Mpa
 Weight Of **PRM-BP-15-P:** 6.25kg
 Weight Of **PRM-BP-15-M:** 8.95kg

LLDPE HIGH PRESSURE
 15KG BUCKET PUMP
 PRM-BP-15-P



TECHNICAL DATA 15KG: HIGH VOLUME VARIATION:

Hose Length: 1.5m
Delivery Volume: 6g/stroke
Pressure Output: 25Mpa

15KG METAL VOLUME
 BUCKET PUMP
 PRM-BP-15-M

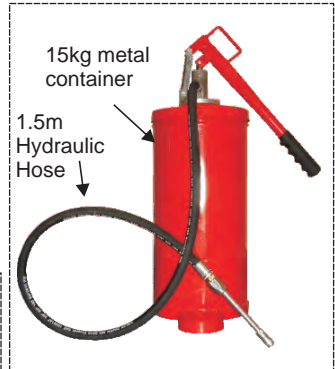

TECHNICAL DATA 5KG:

Hose Length: 1.5m
Delivery Volume: 271g/20 strokes
Pressure Output: 42Mpa
 Weight Of **PRM-BP-05-M:** 6.85kg

5KG METAL
 BUCKET PUMP
 PRM-BP-05-M

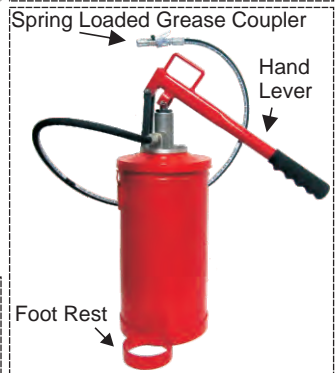

PUMPRITE KNAPSACK GREASE PUMP

The Knapsack Grease Pump is portable. It has its own 7kg container. This pump is specifically designed for servicing grease points situated in difficult places. It is Ideal when the operator requires both hands for e.g. Climbing or where lubrication points are set far apart as in many civil engineering projects such as hydro-electric schemes, dam building etc.

The complete pump comes with the New Patented **Spring Loaded 4-Jaw Grease Coupler**. A button head coupler is available on request. The standard length hydraulic hose is 1.5m but this length can be varied on request. The knapsack grease pump is only available in metal.

TECHNICAL DATA

Hose Length: 1.5m

Delivery Volume: 3g/stroke

Pressure Output: 21Mpa

Weight Of Pump: 9kg

Knapsack pump code:

PRM-KS-07-M



SINGLE PERSON OPERATION WITH THE
SPRING LOADED GREASE COUPLER

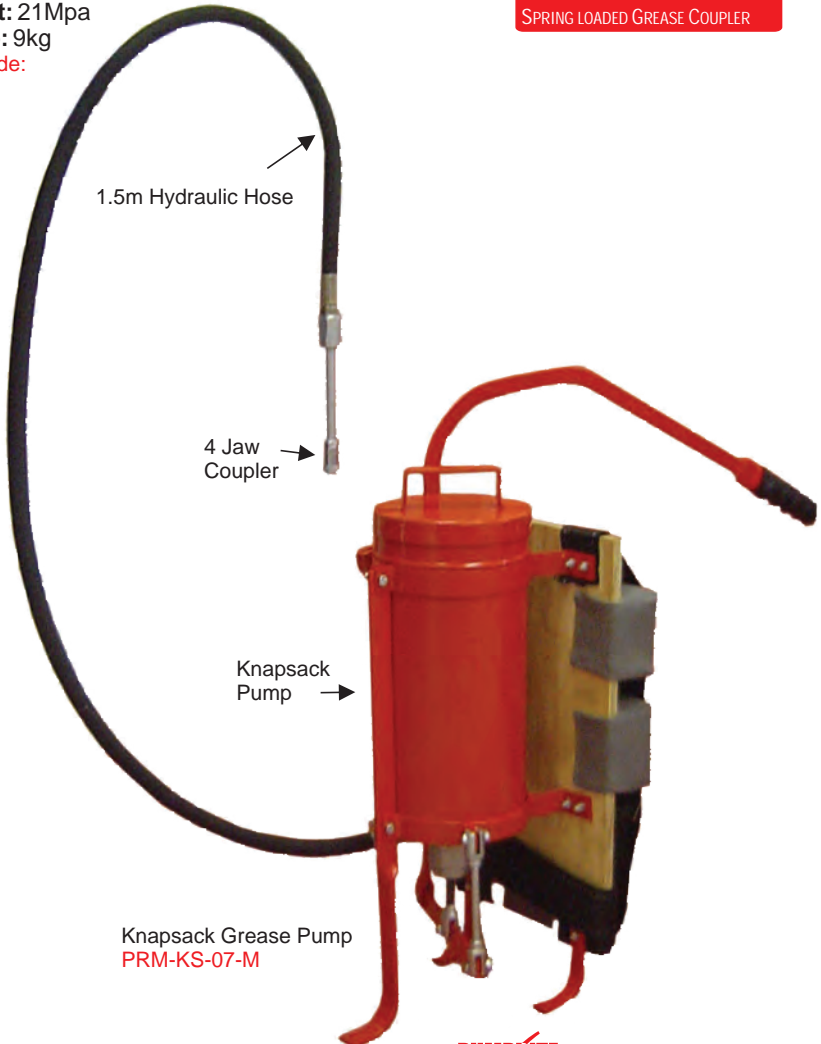

Knapsack Grease Pump
PRM-KS-07-M

PUMPRITE OVAL BUCKET GREASE PUMP



The very impressive MK-2 Oval Bucket Pump has a 3 pin system that allows for delivery variations according to the application.

The Oval Bucket Grease Pump is portable and manually operated. It comes with a **20kg robust, durable, lightweight LLDPE Polyethylene** container.

The complete pump comes with **The Patented Spring Loaded 4-Jaw coupler**. A button head coupler is available on request. The standard length hydraulic hose is 1.5m but this length can be varied on request.

TECHNICAL DATA:

Hose Length: 1.5m

Weight Of Pump: 12kg

Pressure Output: 25 Mpa

PIN POSITION 1 - LOW VOLUME / HIGH LUBE VISCOSITY

🔧 **Delivery Volume:** 190 g/ 20 strokes using Lithium EP 2

🔧 Best for heavy lubes where an easy pump action is required.

PIN POSITION 2 - MEDIUM VOLUME / MEDIUM LUBE VISCOSITY

🔧 **Delivery Volume:** 205g/ strokes

🔧 Best for Medium Viscosity Lubrication where the Pump Action is sustainable.

PIN POSITION 3 - HIGH VOLUME / LOW LUBE VISCOSITY

🔧 **Delivery Volume:** 220g/ 20 strokes

🔧 The shortened leverage allows for the highest volume - Best for Low Viscosity Lubrication.



G GUN - FOOT OPERATED GREASE PUMP



The G Gun is a portable foot operated greasing unit with its own 7.5kg container used to load grease from a larger container. It is operated by a single person.

- It is a patented two stage self priming pump.
- Copes with air pockets.
- All moving parts are submerged and lubricated by grease.
- It is balanced and easily portable with a handle that hinges away for easy filling.

The complete pump comes with **The Patented Spring Loaded 4-Jaw coupler**. A button head coupler is available on request. The standard length hydraulic hose is 2m but this length can be varied on request.

TECHNICAL DATA:

Hose length: 2m

Delivery volume: 3g / stroke

Output pressure: 63mpa

Weight: approx. 9kg

G Gun Code:

G-GUN

Low cost repairs done on these units when required. Spares are readily available.



ONE-HAND LEVER GREASE GUN

One-Hand Grease Gun 85/PK Zinc manufactured in Germany.

- ✍ With high quality zinc-plated steel barrel
- ✍ For 400 g grease cartridges or 500 ccm bulk grease
- ✍ With TWIN-LOCK® system and patented EVER-Flow system
- ✍ Standard air release valve

This TWIN-LOCK® One-hand grease gun offers you many possibilities. The one-hand operation allows for lubricating even hard to reach spots.

Our proven powerswitch system provides the opportunity to adjust the grease supply from high volume to high pressure. Just press the button on the handle, and you will obtain optimal performance.

Either a Flexible or Rigid Spout can be fitted to the One-Hand Lever Grease Gun.

The One-Hand Lever Grease Gun is supplied with a **German Precision 4-Jaw Grease Coupler**.



*Grease Cartridge refills
are available for the
Hand Lever Grease Gun*



HAND LEVER GREASE GUN

The Hand Lever Grease Gun is manufactured in Germany. This manual, portable greasing unit comes with a 500g container that is filled by unscrewing the pump tube & inserting the open end of this 500g container into your larger grease container. You then withdraw the suction lever until it is fully extended. You then reattach the tube and pump head and release the catch.

The Hand Lever Grease Gun has a seamless bore and a long length lever for an easy pumping action. The complete pump comes with a **German Precision 4-Jaw Coupler**. A button head coupler is available on request. The flexible hose option can be used in place of the standard rigid tube to facilitate access.

TECHNICAL DATA

Delivery Volume: 2g/stroke

Output Pressure: 18Mpa

Weight of Pump: 1.4kg

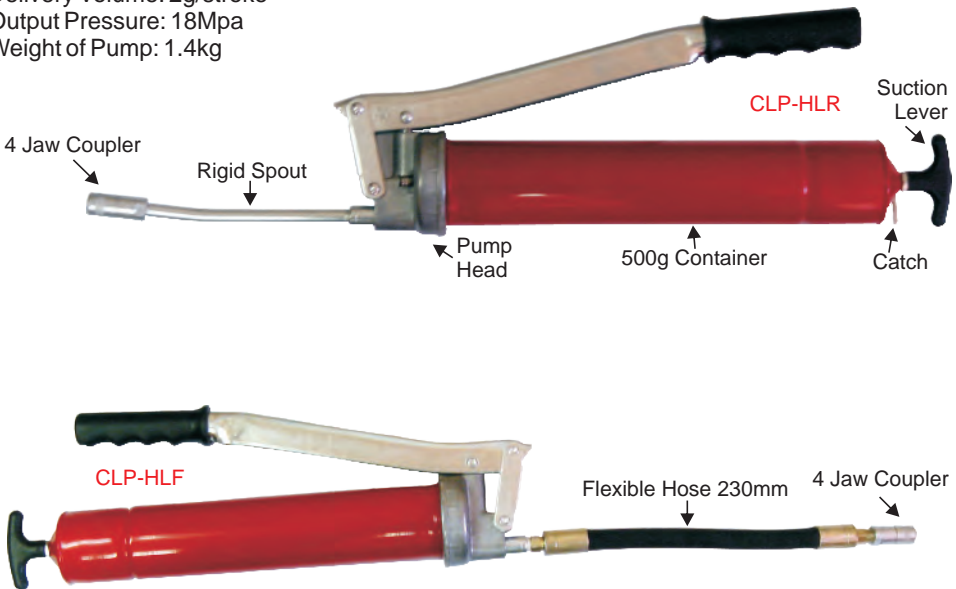

Grease Cartridge Refills are available for the Hand Lever Grease Gun.

*Grease Cartridge refills
are available for the
Hand Lever Grease Gun*



SECTION 3.

PUMPRITE RETRACTABLE HOSE REELS

**S-Series
Rotary Couplings**



**Various
Control Handles
and Nozzles**



**Medium Duty
Swivel Reel**



**Slimline
Heavy Duty Reel**



**Heavy Duty
Reel**

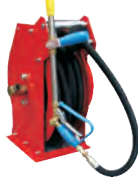

**Super Duty
Reel**

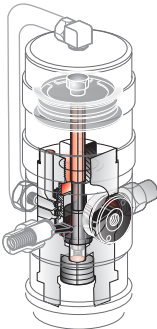

PUMPRITE
Est. 1978

SECTION 3: HOSE REELS

There are four hose reels manufactured in the PUMPRITE range within South Africa; namely:

The Swivel Medium Duty Reel,







The Slimline Heavy Duty Hose Reel,

The **New Development MK-2** Heavy Duty Hose Reel, and





The Super Duty Hose Reel.

*The Newly developed MK-2 Heavy Duty
Hose Reel can now take up to 25m of
½"1 Wire Hydraulic Hose.*

PUMPRITE HOSE REELS:

-  Are retractable and work on a spring load system.
-  The spring steel used is a high quality, hardened and tempered material that is wound, housed & side mounted for robust reliable service.
-  Hose extension and retraction are facilitated by non stick rollers.
-  All components are blackened or powder coated for high corrosion resistance.
-  Pumprite Hose Reels Can be used for relaying grease, oil, diesel, water and air.
-  Can be wall, floor or ceiling mounted for workshop use or field servicing of vehicles, heavy equipment and machinery.
-  Can be swivel mounted.

PUMPRITE Hose Reels working to your Requirements:

-  Housing for banks of reels can be made up to specification
-  Length & specification of retraction hose, retraction hose end fittings, swivel & pump connection hose can be supplied to requirements.
-  In-Line oil meters and any mounting attachments can be supplied.
-  All reels can be manufactured to other requirements including hand wound versions.

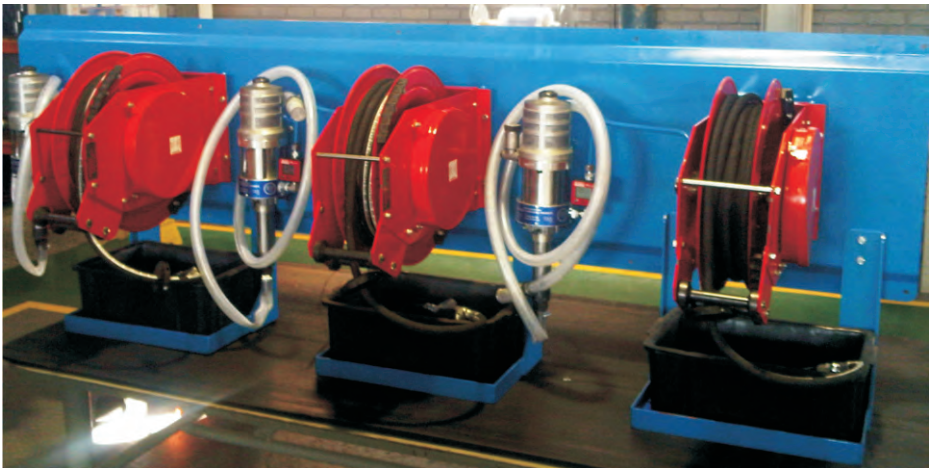

SPARES ALWAYS READILY AVAILABLE FOR THESE PUMPS.
REPAIRS DONE TO ALL MAKES OF PNEUMATIC GREASE PUMPS.

PARKER S SERIES 90° ROTARY COUPLINGS

The Parker S-Series Range of High Pressure Hydraulic Rotary Couplings are the preferred range of 90° Rotary Couplings fitted to the Pumprite Range of Spring Retractable reels.

The pressure balanced design of the S Series swivels ensures that as pressures rise there will not be a significant increase in torque – ensuring optimum performance up to 3,000 PSI. The case hardened, forged bodies offer superior performance and durability in even the toughest applications. Parker's compact S Series eliminates hose twist, torque and stress caused by the movement of hydraulic components – the leading cause of hose failure resulting in costly leaks and equipment down time. Over the life of your equipment, adding Parker swivels to hose lines will significantly reduce repair and maintenance costs.





S Series 90° Swivels – Pressure Balanced Performance in a Compact Design

- Pressure balanced design – torque does not significantly increase with pressure
- Compact design fits in tight areas
- One piece forged body – no brazed joints
- Case hardened housing improves strength and service life
- Web hole design maximizes flow and reduces system turbulence
- Dust seals help prevent contamination
- Up to 3,000 PSI / 200 BAR
- 1/4" to 1" sizes available
- Compact 90° design



VARIOUS CONTROL HANDLES

Application, type of fluid, its temperature, expected flow rate are all key aspects when deciding on a control handle.

-  Heavy Duty Nozzles
-  Automatic Shut off Nozzles
-  Manual Refuelling Nozzles
-  High Flow Nozzles

We also supply a number of meters to suit the wide range of nozzles on offer.

GREASE CONTROL HANDLES

Both the flexible and the rigid grease control handles come with a **German Precision 4-Jaw Coupler**. A **button head type coupler is available on request**. The Multi-Rotational Z-Swivel is always supplied with the Grease control handle.

THE FLEXIBLE GREASE CONTROL HANDLE

It enables access to hard to reach points by means of the flexible outlet. A hose of any length can be supplied as required. Please request the flexible grease control handle if required.

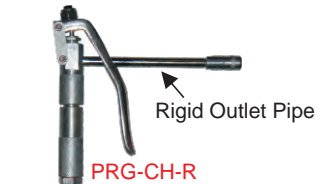
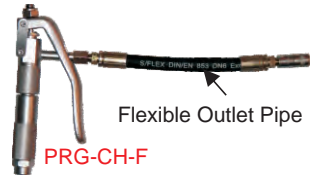

THE RIGID GREASE CONTROL HANDLE

The rigid outlet pipe is normally supplied straight, but can be bent to your requirements. A complete pump comes standard with a rigid grease control handle.



Oil Control Handles:

There is a wide range of Oil Control Handles. The more common Oil Control Handle is the 1/2" Easy Oil Control Handle. We also supply a 3/4" Control Handle. We can offer either a Rigid or a Flexible Spout on any of the Oil Control Handles as well as a range of digital or mechanical meters designed to suit specific control handles.



3/4" Oil Control Handle



1/2" Easy Oil Control Handle Complete with K400 Digital Meter

3/4" OIL CONTROL HANDLE

High Delivery Oil Gun

3/4" F Swivel Inlet

80L/Min

100 Bar Max Pressure

35 Dia Non Drip Nozzle

Rigid Spout with Free Terminal is also available on request.

Viton Seals



Ideal for High Deliveries in Transferring Oil, Lubricants and Allied Products.

WATER SPRAY GUNS

This Machine gun type spray gun can be used in anti-parasite treatment, for fire brigade or for washing purposes.

Materials: plastic handgrip -stainless steel pipe -body and head in brass - O-Ring seal

Standard nozzle: with round hole \varnothing 2,5 mm.

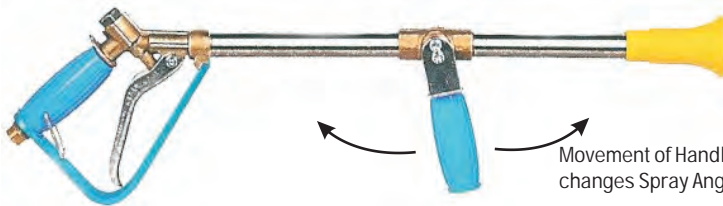

Movement of Handle in directions shown changes Spray Angle

Air Guns and Tyre Inflators

There is a wide range of Air-Gun Nozzles and Tyre Inflators available. Please Request Further information when required.



Diesel / Fuel Nozzles



The fuel dispensing nozzles have been carefully designed to satisfy the need for safety, ease of handling and efficiency. They are available in both manual and automatic versions.

Manual nozzles

The manual nozzles are characterized by high efficiency based on their low flow resistance combined with their notable simplicity of use and economical price. Given their characteristics, they find an application on any fuel transfer system, even those that work by gravity. They are equipped with lever protection, including a removable trigger lock, and are available with a variety of threaded connectors and with reduced section spout for unleaded gasoline.

The **Self 2000** is today still the point of reference in the field of fuel nozzles for manual dispensing. Equipped with a strong aluminum housing with an integrated swivel connector and a hammer-free valve, it functions with low loss of head and is indicated for flow capacities up to 120 l/min.

The **Self 3000** is manufactured with a resistant aluminum body enclosed in a anti-shock plastic shell that increases the nozzle's ease of handling by making the grip comfortable even when used at low temperatures.

The nozzle's integrated swivel connector, and the hammer-free valve inside it, guarantee a high degree of safety. Its low loss of head, given the conformation of the valve, allow it to function at flow capacities up to 150 l/ min. Thanks to the reduced force necessary to open the valve, the Self 3000 nozzle can be used for the transfer of oil with working pressures up to 10 bars (142 psi).

Plastic versions with a flow rate up to 80 l/min are also available. A version for water and food is available.

Description		Flow rate		Inlet		Spout ext. Ø mm	Weight Kg
		l/min	gal/min	without swivel	with swivel		
* Self 2000 1"		120	32	-	F 1" BSP	25	0.7
* Self 3000 1"		150	40	-	F 1" BSP	25	0.6
* Self 3000 1" unleaded spout		150	40	-	F 1" BSP	20	0.6
Plastic nozzle 1" (water/food version)		80	21	Hose tail 1" BSP	F 1" BSP	34	0.2
Plastic nozzle-S 1"		80	21	-	F 1" BSP	34	0.2

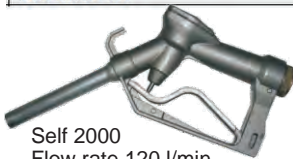

Self 2000
Flow rate 120 l/min
with swivel

Self 3000
Flow rate 150 l/min
with swivel



Plastic nozzle-S
Flow rate 80 l/min
with swivel



Plastic nozzle
Flow rate 80 l/min
without swivel

Recommended
by
PUMPHITE

The Original

Pumprite Swivel Reel

The Pumprite Swivel Reel is the perfect addition to any workshop. It is a lightweight, cost effective reel with a maximum of 15m of hose. It's shaft size allows for a 1/2" swivel outlet. This enables you, the end user, to utilize the Pumprite Swivel Reel for **Air, Water, Grease., Oil, Diesel and any other non-corrosive product.**

The wall bracket allows the reel to swivel on two pivot points when vertically assembled. The reel is also detachable when assembled in this vertical position. When assembled in a horizontal position, the wall bracket becomes void and the reel will remain fixed. (e.g. floor or ceiling mounted)

The Reel will Lock when under pressure. The hose will not retract until the pressure in the system is released. This is an important safety feature as the reel is designed for close proximity working areas.

The reel is fitted with a clutch, this allows freewheel in an anticlockwise direction, making assembly of the hose to the reel a simple task.

This reel is also used in our combination trolley combined with either our 1:1; 3:1 or 4:1 Pumprite Pneumatic Oil Pumps standard for a 210L drum of oil.

TECHNICAL DATA: SWIVEL REEL

Swivels: 1/2"

Hose Length: Anything up to 15m

Maximum Working Pressure: 200 Bar

Weight of Reel: 15kg

NEVER CONNECT RIGID PIPE WORK INTO INLET

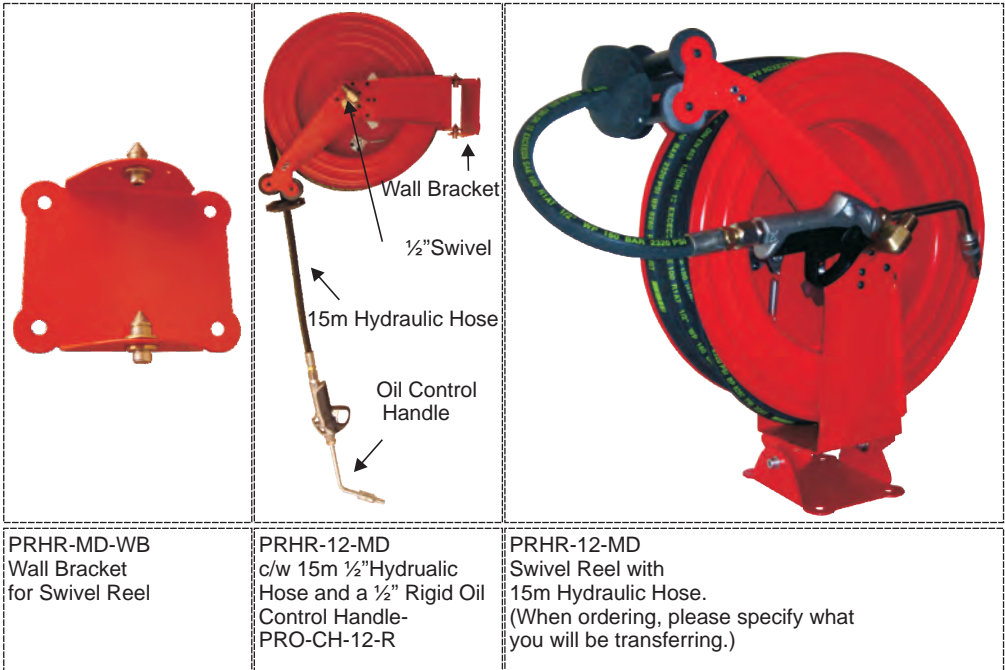

PRHR-MD-WB
Wall Bracket
for Swivel Reel

PRHR-12-MD
c/w 15m 1/2 Hydraulic
Hose and a 1/2 Rigid Oil
Control Handle-
PRO-CH-12-R

PRHR-12-MD
Swivel Reel with
15m Hydraulic Hose.
(When ordering, please specify what
you will be transferring.)

PUMPRITE SLIMLINE HEAVY DUTY REEL

The Slimline Reel is manufactured under the Pumprite Brand of Lubrication Equipment. It has a maximum hose length of 15 meters and is stock produced with either a 1/2" Swivel for Oil, Diesel, Water and Air, or a 3/8" Swivel for Grease and Air.

TECHNICAL DATA: SLIMLINE REEL

Swivels: 3/8", 1/2"

Hose Lengths: Anything up to 15m

Maximum Working Pressure: 500 Bar

Weight of Reel: 25kg

CODING OF SLIMLINE, HEAVY DUTY HOSE REEL:

PRHR-12-LD

PRHR-38-LD

Most suited for applications where very little mounting space is available. Such as a Lubrication Vehicle.

NEVER CONNECT RIGID PIPE WORK INTO INLET

*Due to all possible variations,
All quotes are unique according to
Customer Requests.*

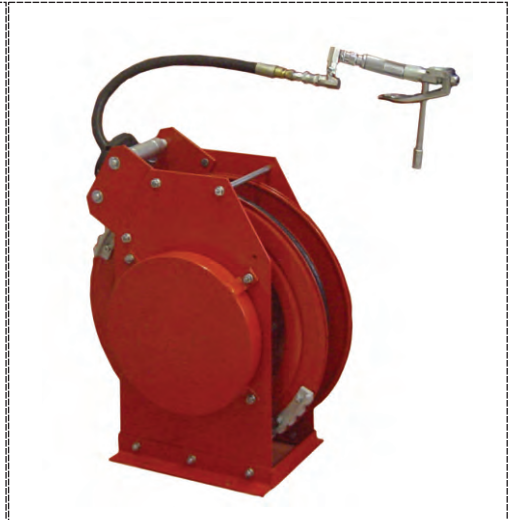

PRHR-12-LD

The Slimline Heavy Duty Hose Reel with 15m 1/2" 1 Wire Hydraulic Hose suitable for oil. Complete with PRO-CH-12-R - Easy Oil Control Handle.

PRHR-38-LD

The Slimline Heavy Duty Hose Reel with 15m 3/8" 2 Wire Hydraulic Hose suitable for Grease complete with a PRG-CH-R, Rigid Grease Control Handle.

PUMPRITE MK-2 HEAVY DUTY HOSE REEL

The Heavy Duty Hose Reel can hold a maximum of 25m 1/2" hose. The swivel arrangement allows for the larger 3/4" Swivel to be attached. This size is perfect for the Transfer of Diesel, or Oil with the very impressive 3/4" Oil Control Handle assembly.

TECHNICAL DATA: HEAVY DUTY REEL

Swivels: 3/8", 1/2", 3/4"

Hose Lengths: Anything up to 25m on the 1/2" and 20m on the 3/4"

Maximum Working Pressure: 500 Bar

Weight of Reel: +-40kg

*Due to all possible variations,
All quotes are unique according to
Customer Request.*

CODING OF HEAVY DUTY HOSE REEL:

PRHR-38-HD

PRHR-12-HD

PRHR-34-HD

NEVER CONNECT RIGID PIPE WORK INTO INLET

High Pressure
Spray Gun

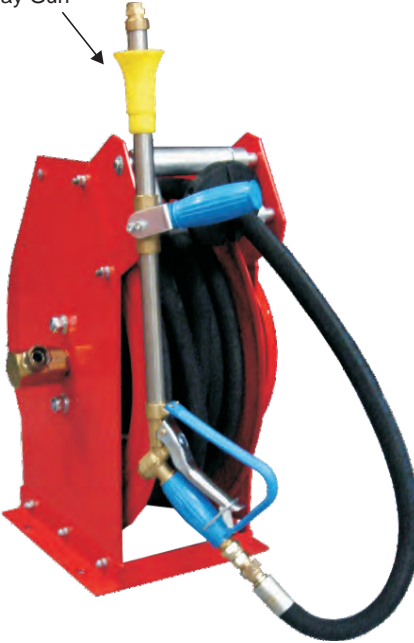

3/4" Oil Control Handle



Heavy Duty Reel with 25m hose complete with Mondial spray gun for water:

Hose Reel Code: **PRHR-12-HD**
Water Hose Code: **HW-12-25**
Spray Gun Code: **CLP-CH-12-W**

Heavy Duty Reel with 20m hose complete with 3/4" Control Handle for Oil:

Hose Reel Code: **PRHR-34-HD**
Oil 3/4" Hose Code: **HO-34-20**
Control Handle Code: **PRO-CH-34-R**

PUMPRITE SUPER HEAVY DUTY HOSE REEL

The Super duty reel can hold up to a maximum of 30m 3/8" or 1/2" Hose and a maximum of 14m 1" hose. Its swivel arrangement allows for a 1" Hose to be connected, thus accommodating the 1" Self 3000 Diesel Bowser. Please note: The Self 300 Has a maximum Working Pressure of 10 Bar.

TECHNICAL DATA: SUPER HEAVY DUTY REEL

Swivels: 3/8", 1/2", 3/4", 1", 1 1/4"

Hose Lengths: Hose Size Specific

Maximum Working Pressure: 500 Bar

Weight of Reel: +45kg

CODING OF SUPER HEAVY DUTY HOSE REEL:

PRHR-38-SD (3/8" Super Duty Reel)

PRHR-12-SD (1/2" Super Duty Reel)

PRHR-34-SD (3/4" Super Duty Reel)

PRHR-10-SD (1" Super Duty Reel)



Complete Super Duty Reel with 25 metres of hose for the Transfer of Oil

PRHR-12-SD

HO-12-25

PRO-CH-12-R



Diesel Bowser

Complete Super Duty Reel with 12 metres of hose for the Transfer of Diesel

PRHR-10-SD

HD-10-12

CLP-CH-S3000

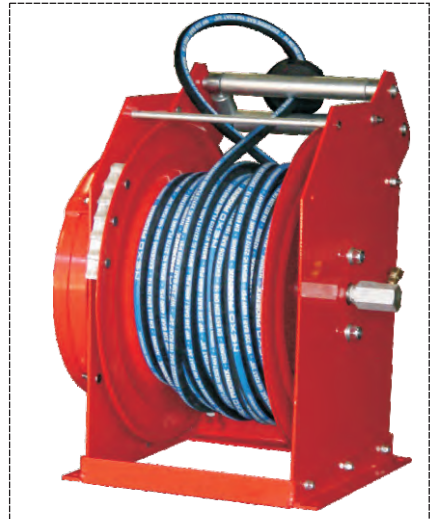

Bare Super Heavy Duty Reel with 30 metres of hose for the Transfer of Grease

PRHR-38-SD

HG-38-30

PUMPRITE HOSE REELS: NOTES PAGE

SECTION 4. PNEUMATIC OIL PUMPS

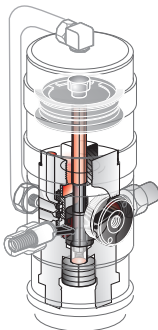
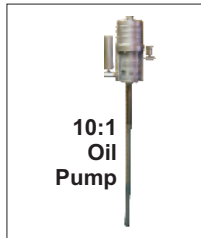







PUMPRITE







Est. 1978

SECTION 4: PNEUMATIC OIL PUMPS

There are 7 Pneumatic Oil Pumps in the PUMPRITE range:





-  Pumprite EA 1:1 Ratio
-  Pumprite EA 3:1 Ratio
-  Pumprite 1:1 Ratio
-  Pumprite 3:1 Ratio
-  Pumprite 4:1 Ratio
-  Pumprite 5:1 Ratio
-  Pumprite 10:1 Ratio.

PUMPRITE PNEUMATIC OIL PUMPS:

-  Are robust and can be stalled without damage. Their design has been refined to ensure failsafe operation & durability in service.
-  Come complete with an airline lubricator for continuous lubrication and protection of the unit. The airline lubricator is fitted to the air inlet of each of the Pneumatic oil pumps. It has its own **air inlet of a 1/4" NPS.**
-  **To Ensure Longevity of your Pump, Please Lubricate the Air Motor using CL1032 Lubricator Oil.**
-  Can be modified for use as a stub pump or a 'long series' to fit 210L drums as well as tailor made to fit various other sized containers.
-  Can be adapted for wall mounting and fitted with a flexible suction hose and strainer.
-  **Maximum air input 10 Bar, Minimum air input 4 Bar.**
-  Delivery volume was derived using 450M Base Oil or SAE 10 Oil or SAE 30 Oil.

PNEUMATIC OIL CODE INFORMATION

All the Pumprite Pneumatic oil pumps are coded according to possible accessories. Please keep in mind that our coding structure is meant for the more common combinations sold. We are flexible to your specific requirements.

-  **PRO** - Pumprite Oil
-  **11/31/41/51/101** - Pump Ratio
i.e. 1:1/3:1/4:1/5:1/10:1
-  **S** - Stub Pump
i.e. Air Motor, Lower Cylinder, Bung Adaptor & Airline Lubricator only.
-  **B** - Bare Pump to suit 210L Drum
i.e. Air motor, Lower Cylinder, riser tube & bung adaptor, and airline lubricator only.
-  **C** - Oil Pump complete to suit 210L Drum
i.e. Bare Pump complete with hose and Spout or Oil Control Handle.

Various Oil Control Handles and Meter Options are Available.

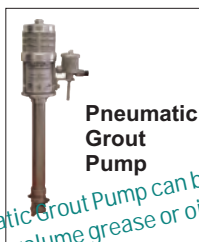

Pneumatic Grout Pump
The Pneumatic Grout Pump can be modified for use as a high volume grease or oil transfer pump.

SPARES ALWAYS READILY AVAILABLE FOR THESE PUMPS.
REPAIRS DONE TO ALL MAKES OF PNEUMATIC GREASE PUMPS.

PUMPRITE EA SERIES 1:1 & EA SERIES 3:1 OIL PUMP

Ensure Air Motor Longevity with
CL1032 Lubricator Oil

The EA Series oil pumps are used for the transfer of low viscosity liquids such as light lubricating oils. We recommend 1:1 Ratio or the 3:1 Ratio where a greater volume, rather than pressure, is required over a short distance. The cylinder is manufactured from honed tubing and is coated by using the "chemically blackened process". The body is anodized for strength and appearance.

TECHNICAL DATA EA 1:1 OIL PUMP

Ratio: 1:1
Size of Outlet: 1" BSP S
Delivery Volume: 40L/min
Pressure Output: 7Bar (7 Bar Input)
Weight Of Pump: Approx. 6kg
EA 1:1 Coding:
PRO-EA-11-S/B/C

TECHNICAL DATA EA 3:1 OIL PUMP

Ratio: 3:1
Size of Outlet: ½" BSP S
Delivery Volume: 14L/min
Pressure Output: 21 Bar (7 Bar Input)
Weight of Pump: Approx. 5kg
EA 3:1 Coding:
PRO-EA-31-S/B/C



PRO-EA-11-S
STUB PUMP



PRO-EA-11-C
COMPLETE PUMP



PRO-EA-31-S
STUB PUMP

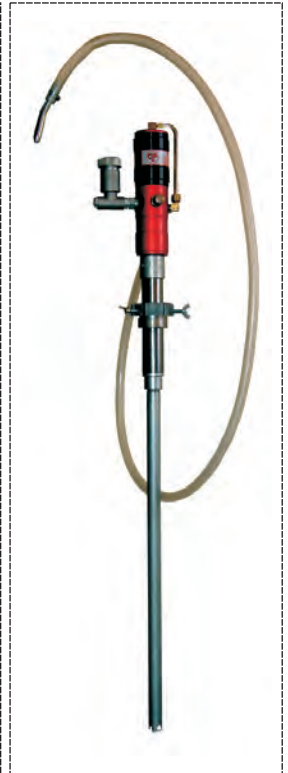

PRO-EA-31-C
COMPLETE PUMP

EA 1:1 OIL TRANSFER PUMP. EXPLODED REPAIR KIT DESCRIPTION

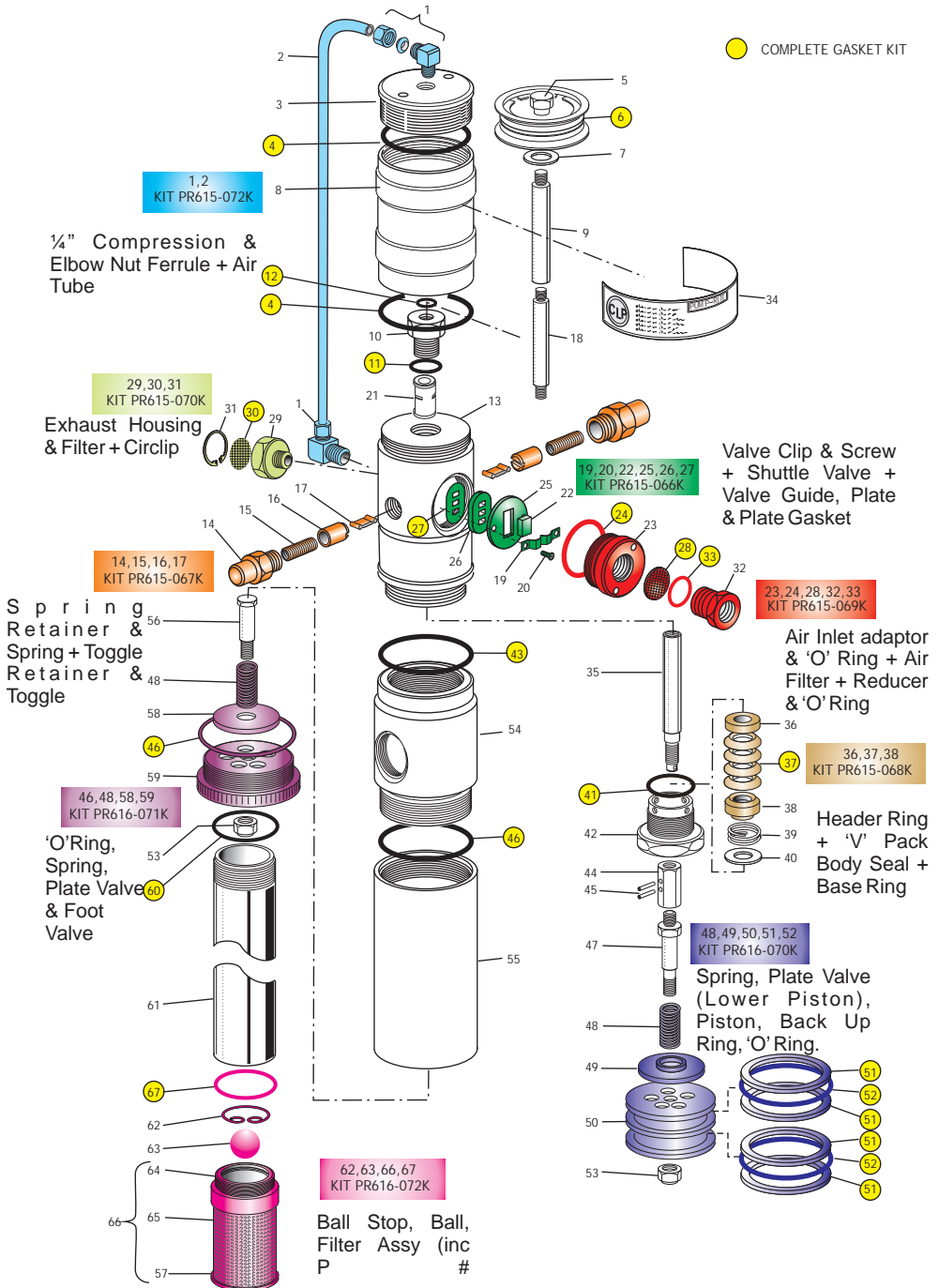

EA 3:1 OIL TRANSFER PUMP. EXPLODED REPAIR KIT DESCRIPTION

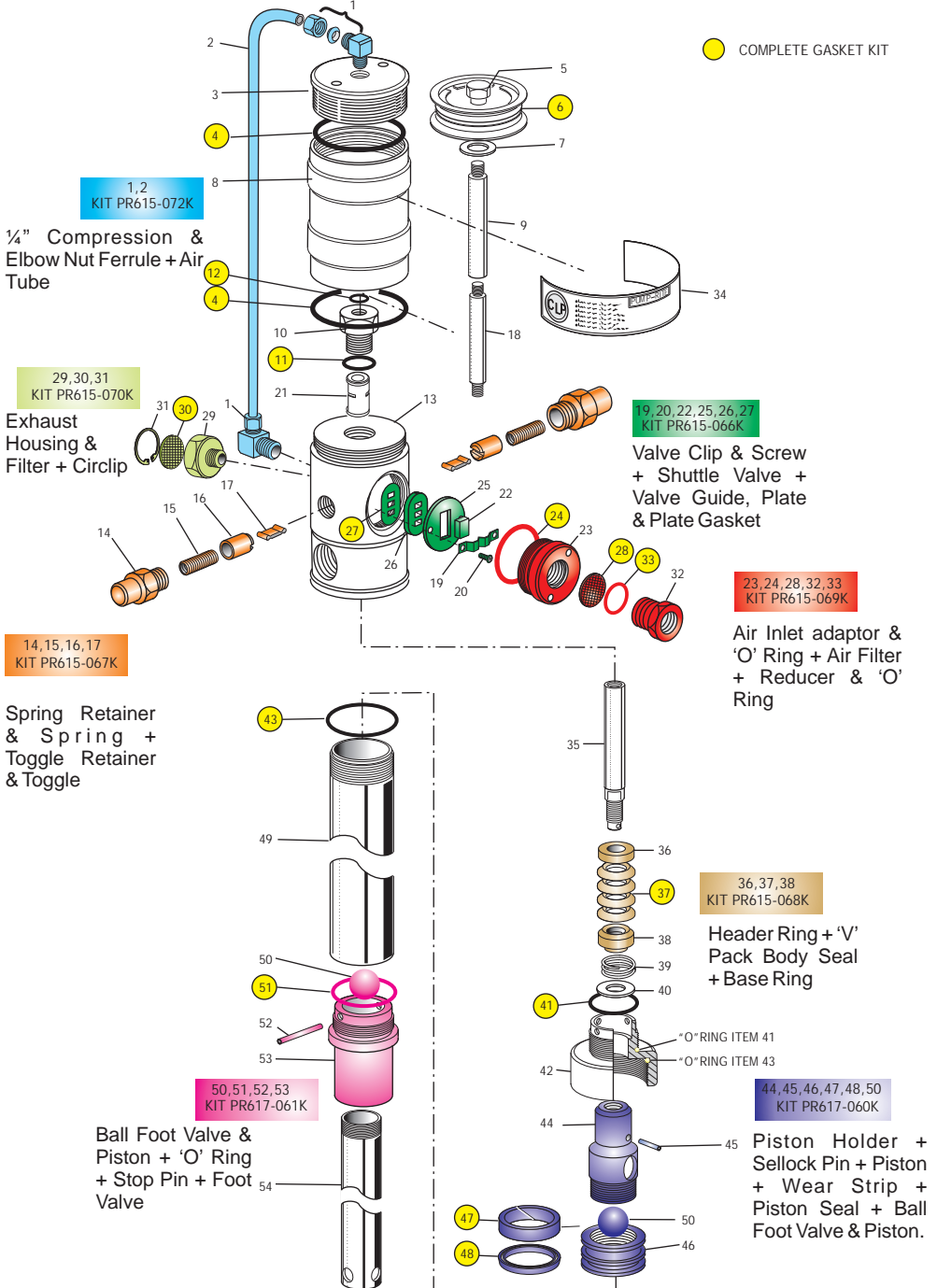

PUMPRITE 1:1 OIL PUMP AND 3:1 OIL PUMP

Ensure Air Motor Longevity with
GL1032 Lubricator Oil

The 1:1 and 3:1 transfer pumps are used for the transfer of low viscosity liquids such as light lubrication oils. The cylinder and body of the pump are **Anodized for Strength and Appearance.**

TECHNICAL DATA

Ratio: 1:1

Size of Outlet: 1" BSP

Delivery Volume: (SAE 10 oil) 40L/min

Pressure Output: 7 Bar (7 Bar Input)

Weight Of Pump: Approx. 6kg

1:1 Coding:

PRO-11-S/B/C

TECHNICAL DATA

Ratio: 3:1

Size of Outlet: ¾" BSP

Delivery Volume: (SAE 10 oil) 15L/min

Pressure Output: 21 Bar (7 Bar Input)

Weight Of Pump: Approx. 6kg

3:1 Coding:

PRO-31-S/B/C

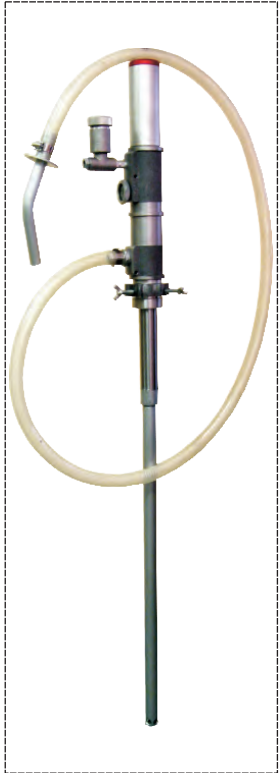
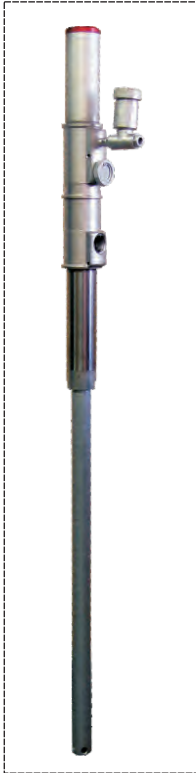
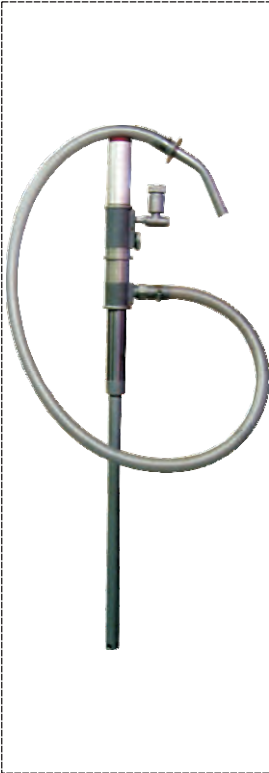

1:1 Stub Pump
PRO-11-S

1:1 Complete Pump
Stub+Riser Tube+
Hose & Spout
PRO-11-C

3:1 Bare Pump
Stub+R/Tube
PRO-31-S

3:1 Complete Pump
Stub+Riser Tube+
Hose & Spout
PRO-31-C

PUMPRITE 4:1 OIL PUMP

Ensure Air Motor Longevity with
GL1032 Lubricator Oil

Probably the most tried and tested oil pump in the Pumprite Range, the 4:1 oil pump delivers a high volume of product at a relatively strong pressure making it the perfect pump where both pressure and volume is important.

The cylinder and body of the pump are Anodized for longer wear life.

TECHNICAL DATA

Ratio: 4:1

Air Inlet: ¼"

Size of Outlet: 1" BSP

Delivery Volume: (450M Base Oil) 50L/min

Pressure Output: 28 Bar Based on 7 Bar Input Pressure

Weight Of Pump: Approx. 13kg



3/4" Oil Control Handle is now recommended with the Pumprite 4:1 1" Oil Pump

4:1 Oil Pump Coding:
PRO 41 S/B/C



Pumprite
4:1 Stub Pump
PRO-41-S



Pumprite 4:1 Bare Pump
PRO-41-B
Suitable for
Standard 210L Drum



Pumprite 4:1 Complete Pump
PRO-41-C
2m Hydraulic Hose &
Rigid Oil Control Handle

PUMPRITE 5:1 OIL PUMP

Ensure Air Motor Longevity with
CL1032 Lubricator Oil

The cylinder and body of the pump are Anodized for Strength and Appearance. The 5:1 complies with the industry standard for normal oil pumping applications.

TECHNICAL DATA

Ratio: 5:1

Size of Outlet: ½"NPS

Delivery Volume: (SAE 30 oil) 15L/min

Pressure Output: 35 Bar Based on 7 Bar Input

Weight Of Pump: Approx. 13kg

5:1 Oil Pump Coding:

PRO-51-B

PRO-51-C



Pumprite 5:1 Bare Pump
PRO-51-B
Suitable for
Standard 210L Drum



Pumprite 5:1 Complete Pump
PRO-51-C
2m Hydraulic Hose &
Rigid Oil Control Handle

PUMPRITE 10:1 OIL PUMP

Ensure Air Motor Longevity with
CL1032 Lubricator Oil

The Pumprite 10:1 Oil Pump ensures a high pressure delivery of oil with the help of the large G200 6" Air Motor. The cylinder and body of the pump are Anodized for longer wear life. The 10:1 is used for more viscous product or pumping over long distances.

TECHNICAL DATA

Ratio: 10:1

Size of Outlet: 1/2" NPS

Delivery Volume (SAE 30 oil): 15L/min

Pressure Output: 70 Bar Based on 7 Bar Input

Weight Of Pump: 19kg

10:1 Oil Pump Coding:

PRO-101-B

PRO-101-C



Pumprite
10:1 Bare Pump
PRO-101-B



Pumprite 10:1 Stub Pump
with Extended Lower Cylinder
Suitable for Standard
210L Drum. Please Enquire



Pumprite 10:1 Complete Pump
2m Hydraulic Hose &
Rigid Oil Control Handle.
PRO-101-C

ACCESSORIES

OIL CONTROL HANDLES

The rigid & flexible oil control handles are fitted with a spring loaded, non-drip nozzle & swivel for 360° rotation. The Easy Oil Control Handle can be fitted with the K400 meter to pump known quantities of product.

TECHNICAL DATA

Max pressure rating: 70 Bar

Inlet Size: ½" BSP

Volume: 15 litres/min

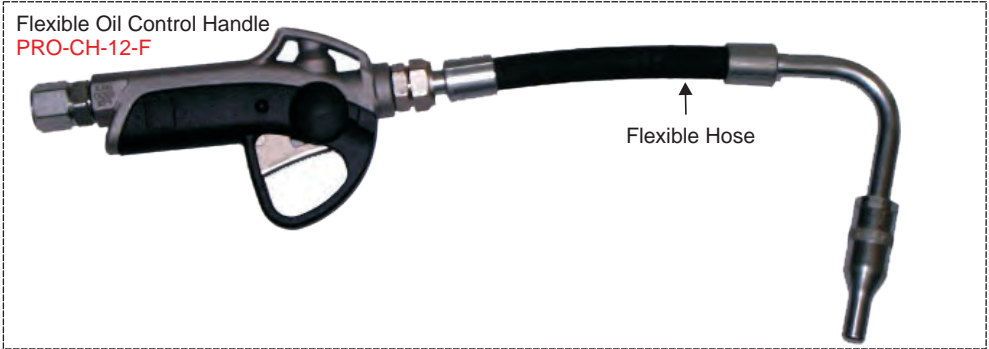

K400 METER

The K400 meter is a four digit meter that fits into the control handle itself. This is of great use and convenience as you always have the meter reading at your trigger point.

Oil Control Handle with
K400 Meter.

PRO-CH-K400-R

PRO-CH-K400-F

Section 5. Manual Oil and Fuel Pumps

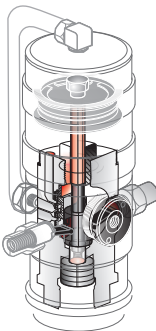
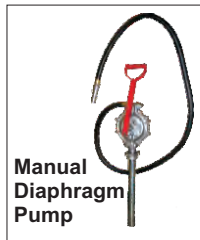
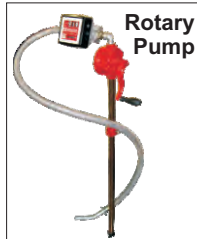
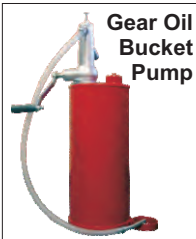

Section 5: Manual Oil and Fuel Pumps & Accessories

There are 4 manual oil pumps manufactured & supplied under the Pumprite Range of Lubrication Equipment; namely the PUMPRITE Gear Oil Bucket Pump, the Barrel Mounted Rotary Pump, the K2 Wing Pump and the Double Diaphragm Fuel Pump..

All of these above pumps can be fitted to a 50 litre, 75 litre and a 100 litre container with coding as shown below:



Gear Oil Bucket Pump

Gear Oil Bucket Pump on a 50 litre container with roller cart:
CLP-GO-50-HDC

Gear Oil Bucket Pump on a 75 litre container with roller cart:
CLP-GO-75-HDC

Gear Oil Bucket Pump on a 100 litre container with roller cart:
CLP-GO-100-HDC



Barrel Mounted Hand Rotary Pump

Hand Rotary Pump on a 50 litre container with roller cart:
CLP-RO-50-HDC

Hand Rotary Pump on a 75 litre container with roller cart:
CLP-RO-75-HDC

Hand Rotary Pump on a 100 litre container with roller cart:
CLP-RO-100-HDC



K2 Wing Pump

K2 Wing Pump on a 50 litre container with roller cart:
CLP-K2-50-HDC

K2 Wing Pump on a 75 litre container with roller cart:
CLP-K2-75-HDC

K2 Wing Pump on a 100 litre container with roller cart:
CLP-K2-100-HDC



50 litre container

**Spark Resistant
Wheels**



75 litre container



100 litre container



CLP-K33-B

K33 METER
3 digit metre
Max input: 120litres/min
Input pressure: 3.5Bar
Output Pressure: 28 Bar
1" BSP Inlet
1" BSP Outlet



BALDWIN FILTER
Flo Rate: 180 litres / min
Micron Rating: 30 Absolute
Media: Sellulose
Height: 142mm
Thread Size: ¾" BSP

CLP-FIL-34

GEAR OIL BUCKET PUMP

The Gear Oil Bucket Pump has a manual pumping mechanism with a semi-rotary action. The handle is turned in a clockwise direction. This lifts the piston to its highest point in approximately 4 turns. The handle is then turned in an anti-clockwise direction. This draws the piston down. This cycle is repeated. At the top of the pump you will see an adjustable screw. This can be adjusted to deliver a determined amount of product.

All parts that are subject to wear and tear are treated to improve longevity in operation. Components exposed to the elements are also treated to prevent corrosion. Its rugged, maintenance free construction makes for a cost effective product.

The complete pump is sold on either a plastic or a metal 20 litre container. It comes with 1.5m of hose and a bent nozzle tip spout. Hose length can be supplied as required. A miniature cart for ease of portability can be supplied if required.

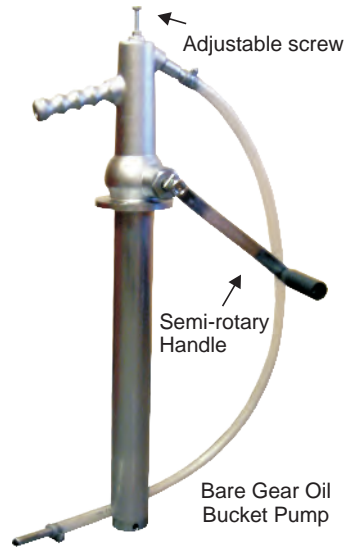

TECHNICAL DATA

- Standard Hose Length:** 1.5m
- Delivery Volume:** 250ml/stroke
- Output Pressure:** 15 Bar
- Weight of Pump:** Approx 11kg

The Gear Oil Bucket Pump can be supplied in multiple colours to suit your requirements. This can be very useful if you have a variety of different oils for specific applications.



Gear Oil Bucket Pump with plastic container
PRM-GO-20-P



The Gear Oil Bucket Pump is available on our 50 litre, 75 litre and 100 litre containers as discussed on the previous page. These containers are mounted onto a roller cart for portable use.

BARREL MOUNTED HAND ROTARY PUMP

The barrel mounted hand rotary pump is a portable oil pump with a full rotary and reverse rotary operation for pumping a wide variety of oils and non-viscous liquids.

This rotary pump is a cost effective means of transferring quantities of oil. The suction tube can be made to customer requirements. The standard pump has a suction tube that fits a 210 litre container. Internally, a carbonized resin impeller is fitted in a cast iron body.

The barrel mounted hand rotary pump is also available WITH A RESETTABLE TOTALISING METER for transferring determinable quantities of oil.

The rotary pump can also be supplied on a 50 litre, a 75 litre or a 100 litre container, just like the Gear Oil Bucket pump, Wing Pump and Double Diaphragm Pump.

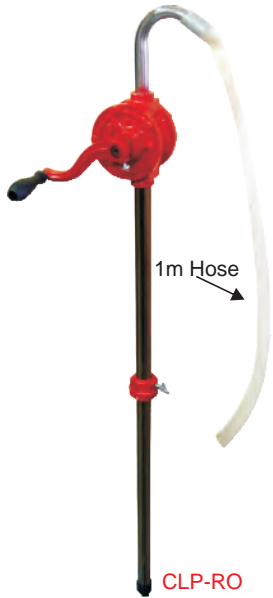

CLP-RO

TECHNICAL DATA

Delivery Volume: 20 litres/min based on 72 turns

Weight of rotary pump with resettable Totalising Meter: approx 10kg

Weight of rotary pump: approx 7kg



Rotary pump with Resettable totalising metre

2m Braided Hose

Rotary Pump

Sieve

← Spout

Rotary pump with 50 litre container on roller cart
CLP-RO-50-HDC

50 litre container on roller cart



BALDWIN FILTER

Flo Rate: 180 litres / min
Micron Rating: 30 Absolute
Media: Cellulose
Height: 142mm
Thread Size: ¾" BSP



K33 METER

3 digit metre
Max input: 120litres/min
Input pressure: 3.5Bar
Output Pressure: 28 Bar
1" BSP Inlet
1" BSP Outlet

DOUBLE ACTING SEMI-ROTARY HAND WING PUMPS

The simple and robust design, quality of materials and workmanship guarantee long and effective service. These pumps are suitable for the handling of clear and light liquids such as water, petrol, diesel and all fuels, paraffin, alcohol, light chemical solutions, edible oils etc. and are the only hand pumps safe for use with very hot liquids – up to 80°C (176°F).

The pumps are operated by the movement of the handle which causes the shaft and the wing piston, fitted with flap valves, to semi-rotate within the pump. Also enclosed in the body of the pump is the suction divider, fitted with flaps. Gland packing compressed by the gland ring and nut acts as a seal between the shaft and the pump cover. The standard model has threaded flanges and is supplied with threaded counter flanges. Two lugs facilitate the mounting of the pump to a wall or similar structure.

The K2 wing pump incorporates many original technical features:

- ✍ Reinforced inlet, discharge and lugs - prevent breakage even if subjected to rough treatment.
- ✍ Tapered internal body - assures automatic settlement of the wings in the body and guarantees smooth, efficient operation.
- ✍ The bare pump can also be adapted to accommodate a 210 litre drum with the addition of a riser tube & a 2m hose complete with spout for easy delivery.

Type	K-00	K-0	K-1	K-2	K-3	K-4	K-5	K-7
Size in inches	3/8"	1/2"	3/4"	1"	1 1/4"	1 1/4"	1 1/2"	2"
Weight* kg	3.2	5.1	6.1	8.8	11.5	12.6	16	32
Double strokes* Per Minute	80	65	60	55	50	50	45	40
Litres Per Minute*	7.5	11.5	17.25	22.5	29	43.25	53.5	90
Delivery in Metres	25	25	25	25	22	22	20	15

* This Data is Approximate

COMPONENTS OF THE "K" PUMP

1. Casing
2. Cover
3. Gland Nut
4. Wing Piston with Flaps & Shaft
5. Suction Divider with Flaps
6. Handle
7. Gland Packing
8. Gland Ring
9. Shaft Nut
10. Washer
11. Counter flange
12. Flange Bolt & Nut
13. Cover Bolt & Nut
14. Flange Joint



Bare K2 wing pump
CLP-K2-B



Suction lift –7m for all sizes For prolonged use at depth below 3m, a foot valve should be fitted.

K SERIES WING PUMPS MOUNTED ON VARIOUS CONTAINERS

The K2 Wing pump can be connected to a container of any size. The diagram shows the K2 Wing Pump connected to a 1000 Litre container with a Totalising Meter that enables the user to pump determinable amounts of product from the container.

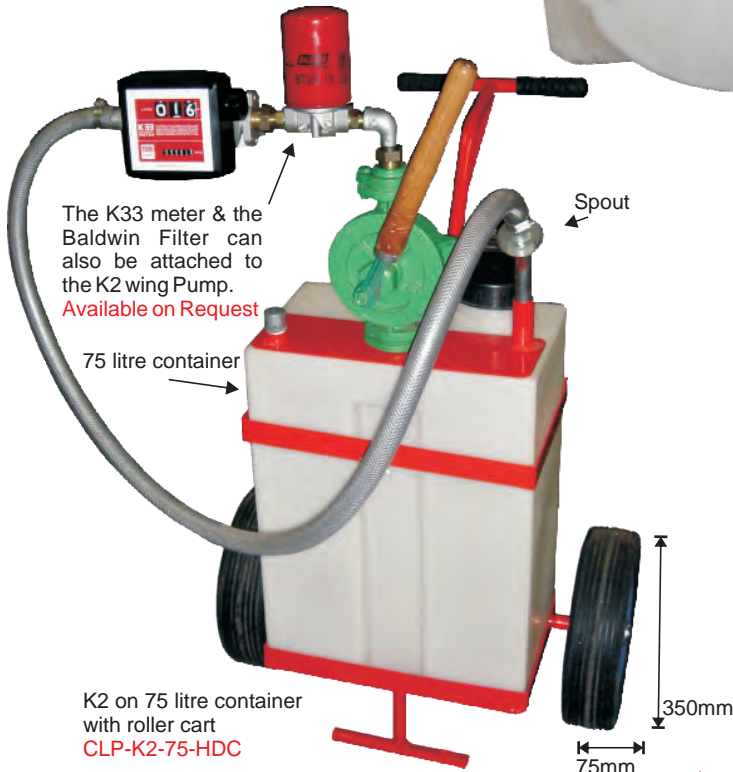

DOUBLE DIAPHRAGM PUMP

The Double Diaphragm Pump has a remarkably easy Reverse Lever Action that dispenses 800ml per stroke. It is recommended for use with petrol, diesel, most oils and other fuels.

DOUBLE DIAPHRAGM PUMP

Features:

- ✦ Heavy duty aluminium die cast construction
- ✦ Includes 2" die cast bung adaptor & extra heavy duty steel handle with security locking latch.
- ✦ Includes telescopic suction tube adjustable to fit 50 to 210 litre drums.
- ✦ Easy dispensing through 2,5m of anti-static neoprene rubber hose with die cast dispensing nozzle.
- ✦ Pump inlet fitted with easy to clean wire mesh screen.
- ✦ Dispenses 800 ml per stroke
- ✦ Designed for use with gasoline, diesel fuel, oil & motor oils.

Components exposed to liquid are made from Aluminium, Stainless Steel, Delrin & NBR rubber

Recommended for use with:

- ✦ Gasoline
- ✦ Diesel Fuel
- ✦ Fuel Oil
- ✦ Motor Oil
- ✦ Petroleum Based media of light to medium viscosity.

Fuels containing Ethanol will cause frequent replacement of rubber parts.

If the pump needs re-priming, take an empty container & place it at the end of the hose. Start operating the pump handle. The initial few strokes should be rapid, this will allow the pump to re-prime and it should start to dispense media in around 7 strokes. Undue pressure on the pump handle may cause the pump neck to fracture.

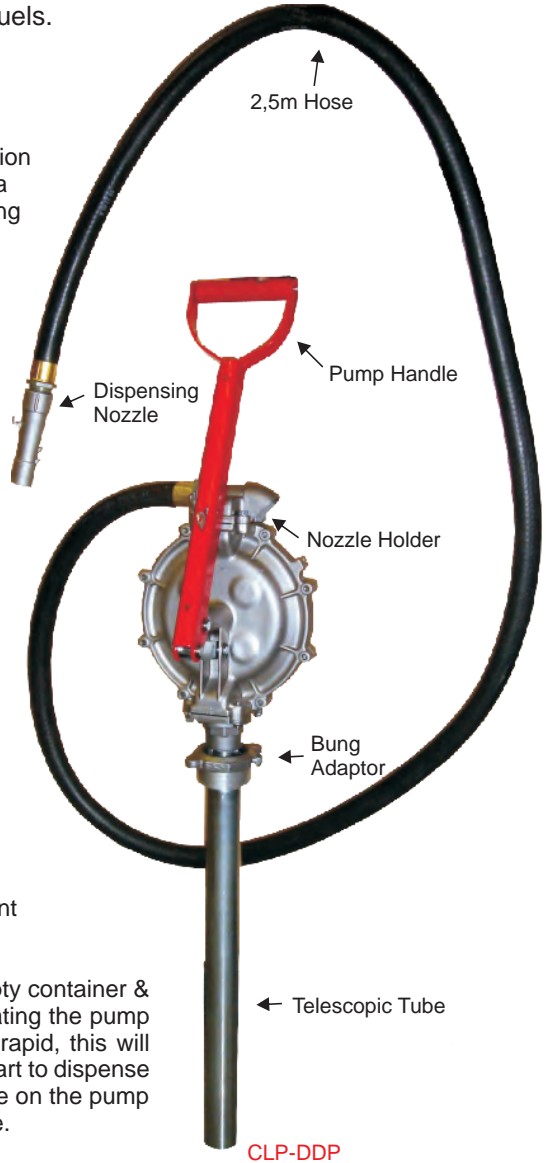

SPILL PROOF PLASTIC FUNNEL

Heavy Duty Polypropylene construction.

Designed with special contours in the funnel body for easy handling.

Anti-Splash & Spill Proof, with rim of the funnel curved in.

Complete with Wire Mesh Screen, Dust Cover & flexible spout.

Available both with and without drum Bung Attachment, which allows the funnel to be mounted direct onto drums with 2" threaded opening.

Manufactured in Translucent white to give a clear view of media.



PUMPRITE MANUAL OIL AND FUEL PUMPS: NOTES PAGE

SECTION 6.

PUMPRITE

GROUT PUMPS & WASH PUMPS

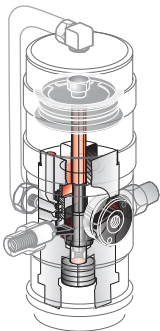
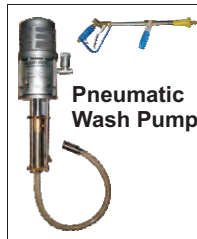
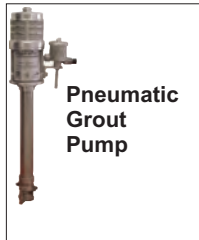

SECTION 6: GROUT PUMPS & WASH PUMPS

The G100 and the G200 Pneumatic Grout pump, the 10:1 Wash Pump as well as the Hand Operated Grout Pump are all manufactured under the PUMPRITE name .

PUMPRITE PNEUMATIC GROUT PUMP

The G200 has a 2 ½" diameter riser tube, whereas the G100 has a 2" diameter riser tube. The air motor is identical for both pumps.

The Pneumatic **G100** and **G200** Grout Pumps have been developed for rock grouting and spraying applications as well as pack setting.

The pump can be modified for use as a high volume grease or oil transfer pump.

The pump is robust and can be stalled without damage. The design has been refined to ensure failsafe operation and durability in service. It comes complete with a filter lubricator for continuous lubrication and protection of the unit. The cylinder and body of the pump are Anodized for longer wear life.

TECHNICAL DATA

Ratio: 10:1

Cycles Per min (no load): 100

Size of Outlet: 1" BSP

Delivery Volume G100: 28 litres/min

Delivery Volume G200: 36 litres/min

Pressure Output (7 Bar input): 70 Bar

Minimum air input: 4 Bar

Maximum air input: 10 Bar

Air consumption: 0.4m³/min

Stroke: 85mm

Weight of Pump: Approx 19kg

Coding for the Grout Pump:

PRG-200-S

PRG-200-B (2 ½" Diameter Riser Tube)

PRG-100-S

PRG-100-B (2" Diameter Riser Tube)

REPAIR KIT

AIR MOTOR: R-PR-200-M

TUBE SECTION: R-PR-200-T



PUMPRITE PNEUMATIC GROUT PUMP SCHEMATIC DRAWING

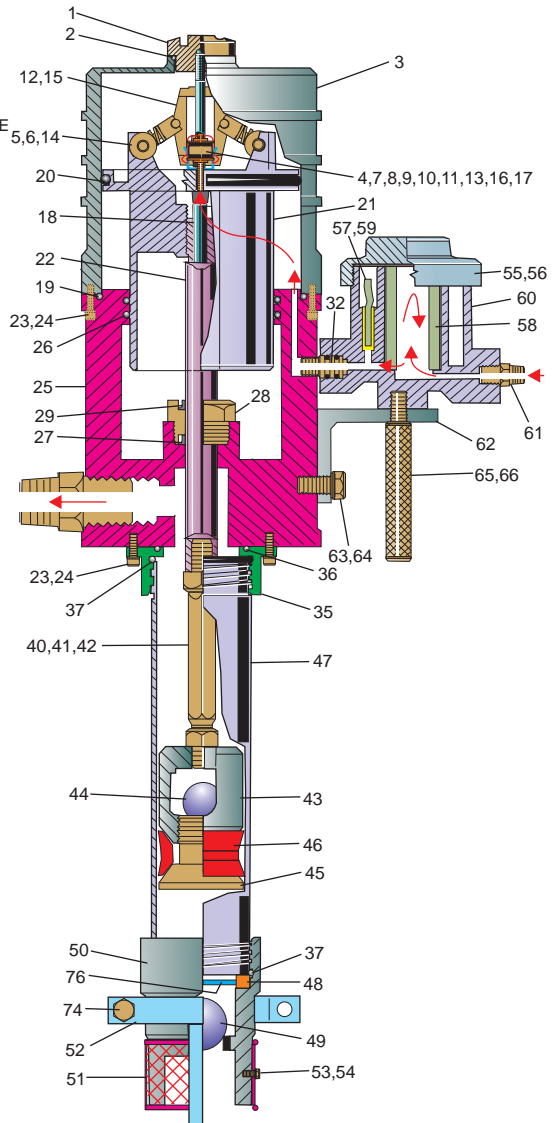
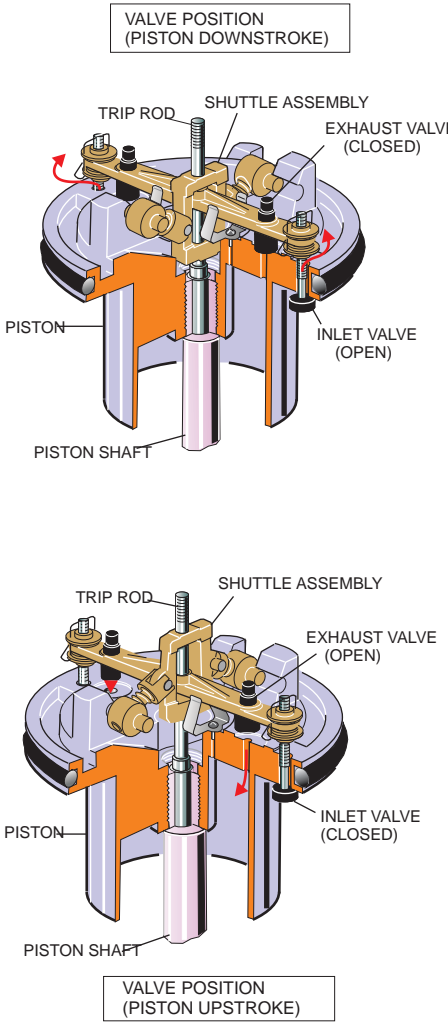

PUMPRITE HAND OPERATED GROUT PUMP

This is a portable, hand operated pump that is used mainly for cementacious product. It can also be used to pump oils and other non-aggressive product. It is designed with a trip action for setting the designated output pressure.

TECHNICAL DATA

Output Pressure: set to 400Kpa

Max output pressure: 650Kpa

Flow Rate: 1litre / stroke

Stroke: 145mm

Outlet: 1" BSP

Wight of Pump: 16kg

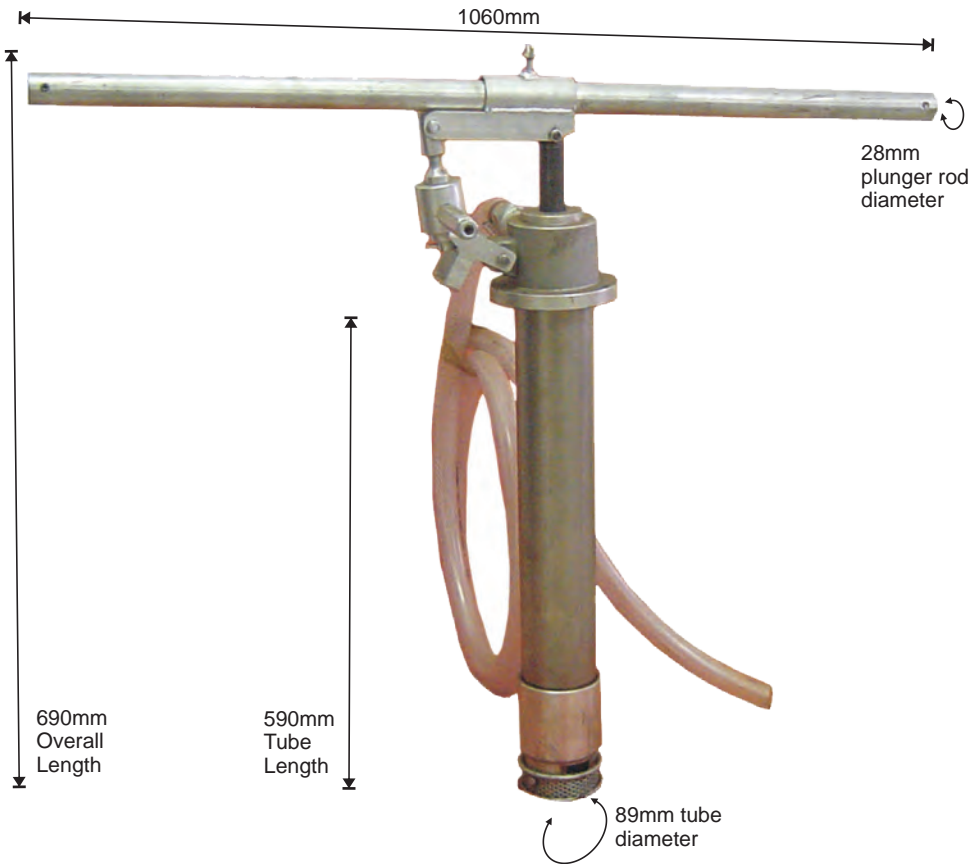

PUMPRITE WASH PUMP

This pump is ideal for high pressure cleaning and spraying of liquids such as paint. It is suitable for foam injection on drill rigs. It can be used with any type of detergent.

This pump is robust and can be stalled without damage. The design has been refined for failsafe operation & durability in service. It comes complete with an airline lubricator for continuous lubrication & protection of the unit. The standard pump comes complete with a suction hose, filter and mounting bracket for fitment onto conventional drums. The cylinder & body of the pump are Anodized for longer wear life. Wetted parts are made in stainless steel & Phosphor Bronze.

TECHNICAL DATA

Ratio: 10:1
Cycles Per Minute: 100 (no load)
Size of Outlet: ½" BSP
Delivery Volume: 12.5L/min
(based on water through high pressure spray gun)
Pressure Output: (input 7 Bar) 70 Bar
Maximum air input: 10 Bar
Minimum air input: 4 Bar
Weight Of Pump: Approx. 18kg

10:1 Wash Pump Coding:

PRW-101-B

Bare pump with suction tube

PRW-101-C

*Pump complete with suction tube,
10m delivery hose & spray gun*

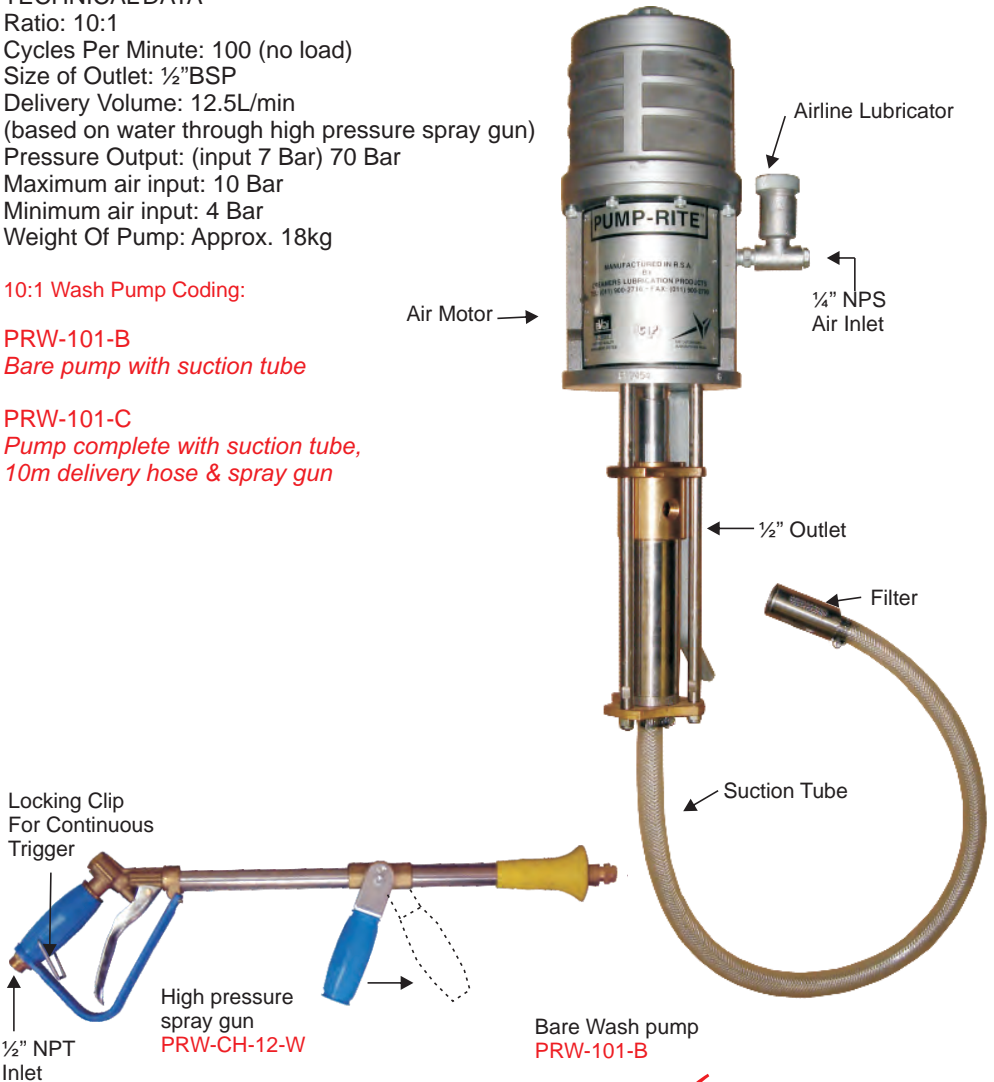

PUMPRITE GROUT AND WASH PUMPS: NOTES PAGE

SECTION 7. CHEMICAL PUMPS

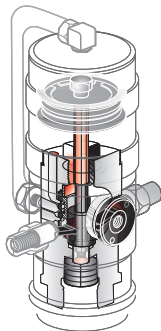
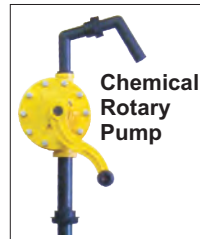

PUMPRITE
Est. 1978



SECTION 07: CHEMICAL PUMPS

The Stainless Steel 4:1 Pneumatic Chemical Pump is manufactured locally in South Africa under the PUMPRITE name. The Chemical Rotary Pump is also readily available.

These pumps are ideal for use with petroleum based products, chemicals, acids, solvents, anti-freeze and all water based media.

STAINLESS STEEL 4:1 PNEUMATIC CHEMICAL PUMP

The Stainless Steel 4:1 pump is used for volume transfer of chemicals and other liquids. The cylinder of the pump is Anodized for longer wear life.

This pump is available in 316 Grade Stainless Steel. All seals are manufactured in Teflon.

TECHNICAL DATA

Ratio: 4:1

Air Inlet: ¼" through the Pumprite Airline Lubricator.

Size of Outlet: 1" BSP

Delivery Volume: (water) 50L/min

Pressure Output: (input 7 Bar) 28 Bar

Weight Of Pump: Approx. 13kg

4:1 Stainless Steel Code:

PRC-41-316-B



CHEMICAL ROTARY PUMP

The main body is constructed from glass filled polypropylene. The pump rotor and vanes are produced in Rayton. The pump comes with a 3 piece suction tube with strainer & 2" bung nut made from glass filled polypropylene. All fasteners and the handle shaft are made from stainless steel. This pump can be secured to numerous sized containers between a 20 litre container and up to a 210 Litre drum.

The hose length can be supplied as required.

TECHNICAL DATA

Standard Hose Length: 1.5m

Delivery Volume: 5.6 litres per 20 turns.

Weight of pump: 1.8kg

Code for the chemical rotary pump: CLP-ROC

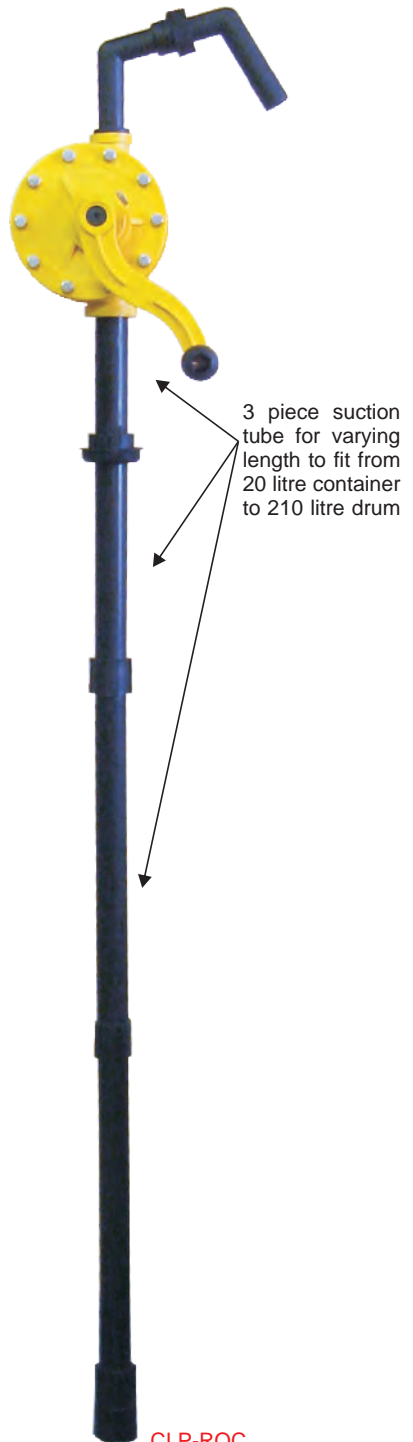
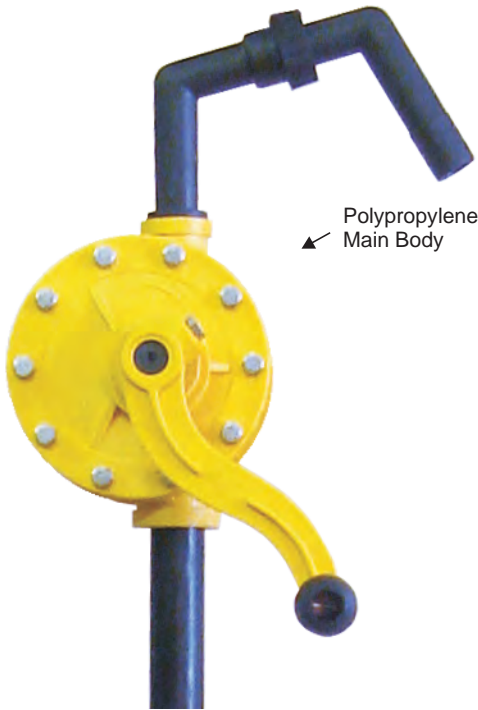

PUMPRITE CHEMICAL PUMPS: NOTES PAGE

SECTION 8. ELECTRIC PUMPS

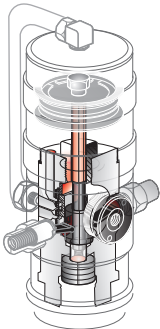

Recommended
by

PUMPRITE
Est. 1978



PIUSI AC 'E' SERIES DIESEL TRANSFER PUMPS

- ✦ Pumping Speeds 75 or 100 L/Min
- ✦ Direct Drive, Self Priming, Vane Pumping Units.
- ✦ 1" BSPF Ports
- ✦ Switch and 2m long Mains Cable
- ✦ Weatherproof to IP55 for Outdoor Use
- ✦ Continuously Rated Motor with Thermal Cut Out
- ✦ Also Available in 380VAC

E80	-	75L / Min
E120	-	100L / Min



PIUSI AC PANTHER DIESEL TRANSFER PUMPS

PANTHER 56 and PANTHER 72 represent the results of a careful analysis of the requirements connected with transferring and distributing Diesel fuel. These self-priming rotary vane pumps feature a mechanical seal that guarantees constant reliability, even in low temperatures.

Compact, safe and dependable, they can be used for equipping fuel pumps and stationary fuel transfer installations.

- ✦ Pumping Speeds 56, 68, 72 L/ Min. 230V
- ✦ Direct Drive, Self Priming, Vane Pumping Units.
- ✦ 1" BSPF Ports
- ✦ Switch and 2m long Mains Cable. Integral Filter & Bypass
- ✦ Weatherproof to IP55 for Outdoor Use
- ✦ Continuously Rated Motor with Thermal Cut Out
- ✦ Also Available in 380VAC

Panther 56



Panther 72



PANTHER 72

Flow rate up to 72 l/min
Filter incorporated

PANTHER 56

Flow rate up to 68 l/min
Filter incorporated

PIUSI VISCOMAT BATTERY DC PUMPS FOR OIL

- ✍ Max Flow 10 L/Min
- ✍ Direct Drive Gear Pumping Unit with Bypass Valve
- ✍ 2m Battery Cable & Croc Clips
- ✍ **Max Run Time: 30 Min**
- ✍ Available in **12V and 24V** Versions
- ✍ Drum Pump Kit includes Hoses, Fittings and Nozzle - Please Enquire



PIUSI AC VISCOMAT VANE PUMP FOR OIL

VISCOMAT is a family of internal profile vane pumps designed as modern, effective solutions for the various requirements of pumping oils and lubricants. Thanks to the available models VISCOMAT satisfies the need to:

- ✍ Transfer large quantities of product at medium pressure between tanks;
- ✍ Guarantee good flow rates at high pressure in applications in which the pump must supply the reeling drums of fixed, "in-line" oil distribution systems on fixed pumping systems;

The main features are:

- ✍ quiet operation,
- ✍ regularity of flow characterized by the absence of pulsations,
- ✍ closed-delivery operation option thanks to the incorporated adjustable **BYPASS**,
- ✍ high suction capacity,
- ✍ compact design.

Performance Characteristics

- ✍ Max. Flow 25-50 L/Min
- ✍ Pressures from up to 6 bar (71 psi).
- ✍ Continuous operation.
- ✍ Noise less than 70 dB.
- ✍ Vane Pump Unit
- ✍ Switch and Bypass Valve
- ✍ Foot Mounting Plate
- ✍ Weatherproof to Ip55
- ✍ Max. Suction Lift 2.5m when used with non-return valve
- ✍ Continuously Rated Motor with Thermal Cut Out
- ✍ Also available in **380VAC**

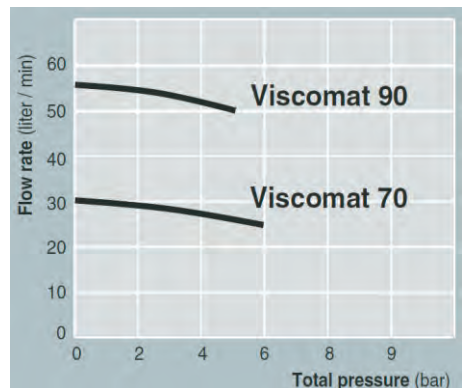



PIUSI VISCOMAT GEAR PUMP FOR OIL

- ✦ Flow rates from 9 to 14 l/min
- ✦ Pressures from 12 to 25 bar
- ✦ Continuous operation.
- ✦ Noise less than 70 dB
- ✦ Switch and Bypass Valve
- ✦ Foot Mounting Plate
- ✦ Weatherproof to Ip55
- ✦ Continuously Rated Motor with Thermal Cut Out
- ✦ Also Available in 380VAC

Viscomat 200	-	9 L/Min @ 12 Bar
Viscomat 230	-	14 L/Min @ 12 Bar
Viscomat 350	-	9 L/Min @ 25 Bar



BATTERY TRANSFER PUMPS - DIESEL AND BIOFUEL

- ✦ Ideal for Mounting into Plant equipment, excavators etc.
- ✦ Max. Flow 50 L/Min
- ✦ 3/4" BSPF Ports
- ✦ 12V or 24V
- ✦ Direct Drive Vane Pumping Unit with Bypass Valve
- ✦ Foot Mounting Plate
- ✦ Weatherproof to Ip54 for Outdoor Use
- ✦ C/W Switch, Carry Handle, 2m Cable and Croc Clips
- ✦ Max. Run Time 30 Min

Portable Battery Kit:

- ✦ Empties 210L Drum in approx. 5 Min
- ✦ Aluminium Manual Nozzle with Inlet Swivel
- ✦ 4m Delivery Hose with robust Swaged Ends



AG-35 12 OR 24 VDC SELF-SUCTION WITH BLADES 0,30 kW · 50 L/MIN - DIESEL

- ✍ Re-circulation Bypass
- ✍ Suction: 2.5 m ·
- ✍ Delivery: 20 m
- ✍ Free flow: 45-50 l/min
- ✍ Consumption: 18-24 A (12 VDC) and 9-17 A (24 VDC)
- ✍ Motor: 0.30 kW (12 and 24V DC) Continuous duty fan cooled motor
- ✍ 3,000 rpm
- ✍ Connection through F3/4" threads
- ✍ 2m cable with clamps
- ✍ Stainless steel filter in the suction of 352 µm (micron)
- ✍ Luminous switch with IP-55 protection



AG-35 Battery Kit

- ✍ AG-35 12 or 24 VDC pump
- ✍ PSF-040 · Manual aluminium nozzle with F1" swivel and curved end
- ✍ 4m antistatic delivery hose Ø19 mm double layer, special for diesel, with adapters in both ends
- ✍ PP Lower filter with STAINLESS mesh
- ✍ 2 brackets 23x35
- ✍ 90° MF 3/4" brass elbow
- ✍ 3/4" PP adapter
- ✍ It is supplied with a printed box, with EAN-13 bar code.



AG-46 230 VAC SELF-SUCTION WITH BLADES 0,25 kW · 50 L/MIN - DIESEL

- ✍ Re-circulation bypass
- ✍ Suction: 5 m
- ✍ Delivery: 30 m
- ✍ Free flow: 45-50 l/min
- ✍ Self priming up to 2.5m 0.25
- ✍ Continuous duty fan cooled motor



AG-90 12 OR 24 VDC SELF-SUCTION WITH BLADES 0,37 kW · 80 L/MIN - DIESEL

- ✍ Flow rates up to 80 l/min
- ✍ Delivery head up to 20m
- ✍ Self priming up to 2.5m
- ✍ Internal recycle valve
- ✍ 400W - IP55 - S1 Continuous duty fan cooled motor



AG-88 (0,37 kW) 230 VAC SELF-SUCTION WITH BLADES 80 L/MIN - DIESEL

- ✍ Flow rates up to 80 l/min
- ✍ Delivery head up to 30m
- ✍ Self priming up to 2.5m
- ✍ Internal recycle valve
- ✍ 0.37kW - 230V/1ph/50Hz - IP55 - S1 Continuous duty fan cooled motor



AG-88 (0,74 kW) 230 VAC SELF-SUCTION WITH BLADES 100 L/MIN - DIESEL

- ✍ Flow rates up to 80 l/min
- ✍ Delivery head up to 30m
- ✍ Self priming up to 2.5m
- ✍ Internal recycle valve
- ✍ 0.37kW - 230V/1ph/50Hz - IP55 - S1 Continuous duty fan cooled motor



Please enquire about the different Flange Options available for the entire Gespasa Diesel Pump range.



Please also note Vertical and Horizontal Assembly options are available.

Recommended by



AG-600 12 OR 24 VDC EExD · 0,18 kW · 50 L/MIN - PETROL

- ✍ Flow rates up to 50 l/min
- ✍ Delivery head up to 20m
- ✍ Self priming up to 2.5m
- ✍ Internal recycle valve
- ✍ 180W - IP55 - S2 30minute cycle motor
- ✍ Certified - EEx d IIB T4 ISSEP02 ATEX036



AG-500 230 VAC EExD · 0,18 kW · 50 L/MIN - PETROL

- ✍ Flow rates up to 50 l/min
- ✍ Delivery head up to 30m
- ✍ Self priming up to 2.5m
- ✍ Internal recycle valve
- ✍ 0.18kW - 230V/1ph/50Hz - IP55 - S2 30minute cycle motor
- ✍ Certified - EEx d IIB T4 ISSEP02 ATEX036



AG-800 230 VAC EExD · 0,37 kW · 80 L/MIN - PETROL

- ✍ Flow rates up to 80 l/min
- ✍ Delivery head up to 30m
- ✍ Self priming up to 2.5m
- ✍ Internal recycle valve
- ✍ 0.37kW - 230V/1ph/50Hz - IP55 - S2 30minute cycle motor
- ✍ Certified - EEx d IIB T4 ISSEP02 ATEX036



MINI DISPENSERS - PETROL - DIESEL.



Mechanical compact supply kit suitable for the diesel and/or petrol transfer to own consumption vehicles.

Please Enquire for more details.

EA-88 (0,37kW) 230 VAC 20-25L/MIN - LUBRICANT

- ✍ Flow rates up to 25 l/min
- ✍ Delivery pressure up to 7 bar
- ✍ Self priming up to 2.5m
- ✍ Internal recycle valve
- ✍ Pumps oil up to SAE140 equivalent viscosity
- ✍ 0.75kW - 230V/1ph/50Hz - IP55 - S1 Continuous duty



EA-88 with pressure switch



EA-90 12 OR 24 VDC GEAR SELF-SUCTION 0,40kW · 20-25 L/MIN - LUBRICANT

- ✍ Flow rates up to 25 l/min
- ✍ Delivery pressure up to 5 bar
- ✍ Self priming up to 2.5m
- ✍ Internal recycle valve
- ✍ Pumps oil up to SAE40 equivalent viscosity
- ✍ 400W - IP55 - S1 Continuous duty fan cooled motor

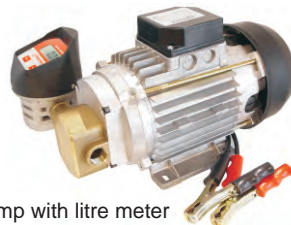

EA-90 12 or 24VDC · Pump with litre meter

EA-10B 230 VAC REVERSIBLE GEARING 0,55kW · 12 L/MIN - LUBRICANT

- ✍ Flow rates up to 12 l/min
- ✍ Reversible flow
- ✍ Delivery pressure up to 14 bar
- ✍ Self priming up to 2.5m
- ✍ Internal recycle valve
- ✍ Pumps oil up to SAE140 equivalent viscosity
- ✍ 0.55kW - 230V/1ph/50Hz - IP55 - S1 Continuous duty



Electric dispenser kit for 1000 litre tank

SECTION 9. MOBILE COMBINATION TROLLEYS

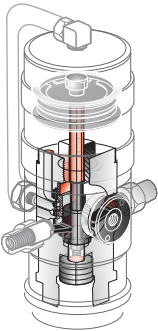

PUMPRITE MOBILE LUBRICATION SYSTEM

The Pumprite Mobile Combination Trolley is ideal for maintenance runs where different Air Supplies are available in different locations. This Trolley combination can be used with any Pumprite Pump combined with our Pumprite Swivel Reel or our Pumprite Slimline Heavy Duty Reel, depending on requirements.

The front of the Trolley has an easy slide design to help place and remove the 210 Litre / 180kg Drum. The use of the drum locator will ensure safe use with minimal spillage.

The Pump can be securely positioned to the side of the trolley when no drum is in use.



The Hose reel is well positioned and securely fitted for utilization.

Heavy Duty Wheels, 2 fixed in the front and 2 swivelled at the back, allow for a smooth motion when trolley is mobile.

This mobile unit is also available without the Hose Reel - Thus ideal for manual oil

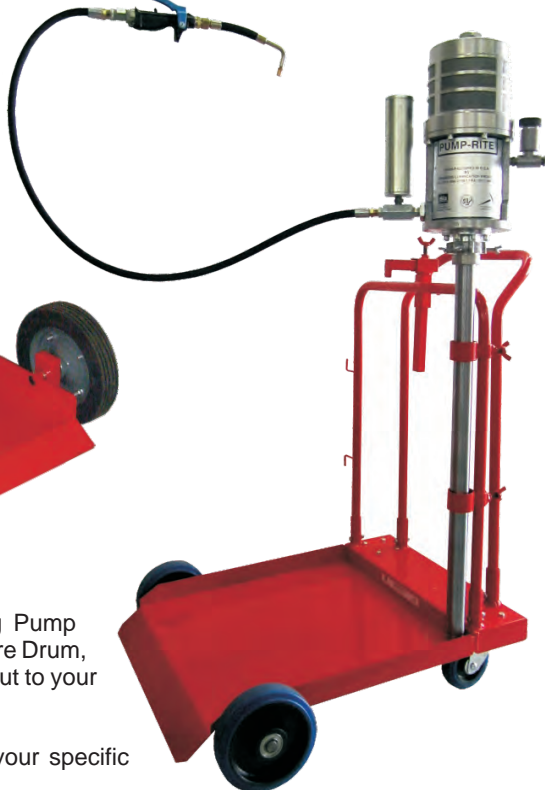

and fuel pumps, such as the K2 Wing Pump complete with Riser Tube to suit a 210 Litre Drum, Pump Securing Adaptor, Braided Hose cut to your required length and a 1" Spout.

Pumprite products can be adapted to your specific requirements.

